



**FORMULA RENAULT 2.0
2009
CHASSIS**



30

CHASSIS

Overview 30-1
Suspension fastening points..... 30-5
Suspension adjustment Tables 30-9

31

FRONT AXLE ASSEMBLY

Presentation 31-1
Adjustments..... 31-2
Hub carrier 31-3
Wheel bearing 31-6
Spring-damper set..... 31-7
Antiroll 31-12

32

REAR AXLE ASSEMBLY

Presentation 32-1
Adjustments..... 32-2
Hub carrier 32-3
Wheel bearing 32-6
Wheel hub 32-7
Spring-damper set..... 32-8

33

WHEELS AND TYRES

Characteristics..... 33-1

34

STEERING ASSEMBLY

Steering rack 34-1

35

BRAKES

System components 35-1

36 **THROTTLE COMMAND**
 Recommendation36-1

37 **AERODYNAMICS**
 Wings37-1

CHARACTERISTICS

- Front suspension: single-damper push rod.
- Rear suspension: bi-damper push rod.
- Dampers: adjustable compression travel and rebound travel.
- Springs: four rigidity front and rear spring stiffeners. Helical type.
- Brake callipers: four pistons.
- Brake discs: 274x17.5mm, ventilated.
- Rims: middle fastener.
 - front : 8x13,
 - Rear: 10x13.
- Wheelbase: 2,645mm.
- Front track: 1,471mm.
- Rear track: 1,366mm.
- Weight: 490kg.
- Fuel tank capacity: 39L.

PRESENTATION

Body structure

The body structure is made up of an aluminium honeycomb structure with a vacuum-kilned carbon fibre skin.

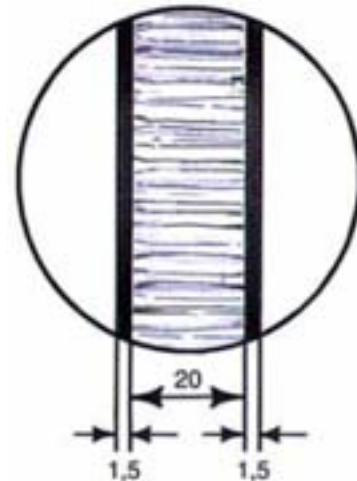

Three aluminium bulkheads (1) take up the loads of the engine and suspension fasteners.

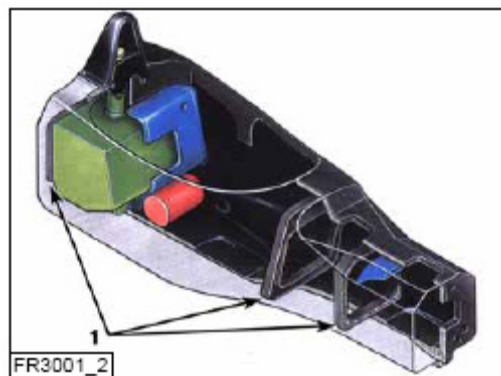

Identification

It is executed by:

- A plate (1) fixed on the left side of the body.



- A sticker stuck on the body under the head protection.



SAFETY TESTS

NOTA: All tests are performed in accordance with standard FIA F.3.

Load test on safety roll bar

This test was performed with the safety roll bar installed on the chassis. Three forces equivalent to 7.5, 5.5 and 1.5 times the weight of the car with the driver in it, were applied simultaneously:

- Vertically.
- Longitudinally.
- Laterally.

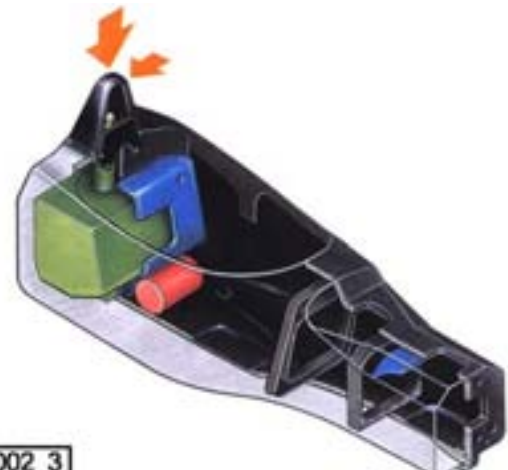

FR3002 31

Lateral load test on body structure

The body structure was subjected to various lateral load tests, from 1000 to 2000kg.

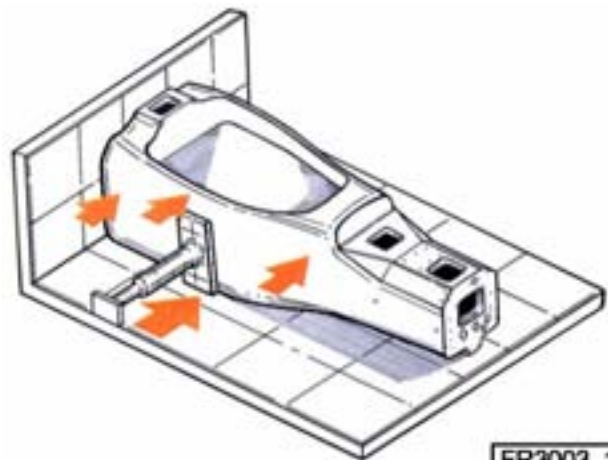

FR3003 1

Frontal crash test and nose fastening test

- Nose fasteners were subjected to a lateral load of 30.00 kN.
- The front crash test, with the nose installed on the chassis, was carried out at a speed of 12.5 m/s.

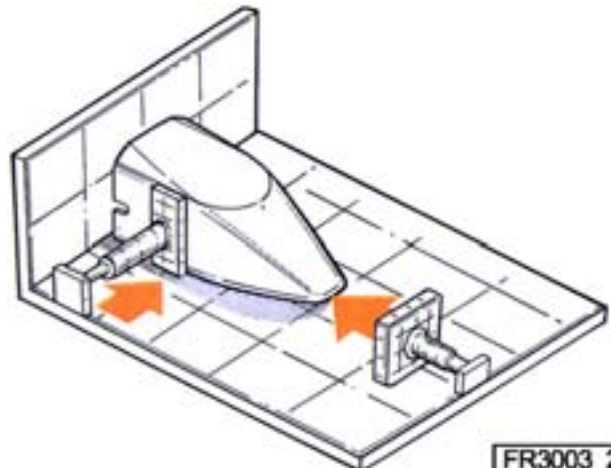

FR3003 2

Steering column test crash

The test was performed on a tube fitted with its mountings. The impact on the steering wheel was made with a weight of 8kg, at a speed of 7m/s.



HANS SYSTEM (ACCORDING TO SPECIFIC REGULATIONS)

In some championships, the safety belts support (ref. 77 11 154 981) necessary to attach the HANS-compatible harness shoulder straps is mandatory. It has to be attached in place of the original shoulder straps.

THE INSTALLATION INSTRUCTIONS OF THE SAFETY BELTS SUPPORT

- Remove the fuel tank, then rebores the existing harnesses holes with an 8,5mm diameter in order to remove the threading.
- Open the tank panel and position the rear plate, please note that the smooth face must be in contact with the bulkhead. The two bolts M8x25 button head in the centre holes will hold the plate in position. The bulkhead should have a flat carbon surface on the tank side, if necessary, you can improve the flatness adding some epoxy resin.
- Now you can install the HANS adapter using the four M8x45 countersunk bolts. Note that you can reverse the bracket to adjust the height of the belt fixation.
- The two remaining screws are necessary to fix the belt bracket on the adapter.

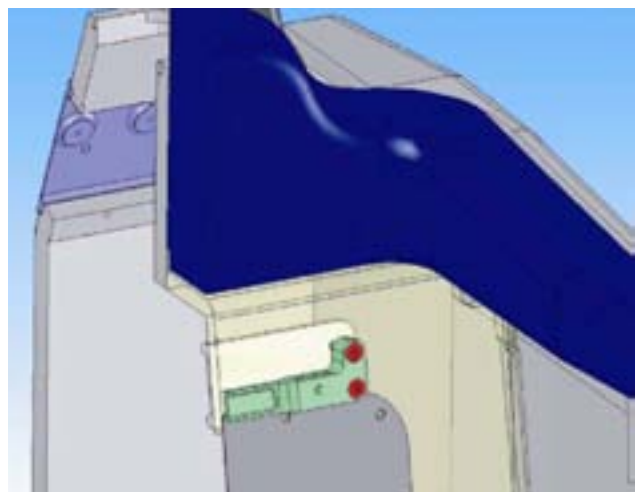
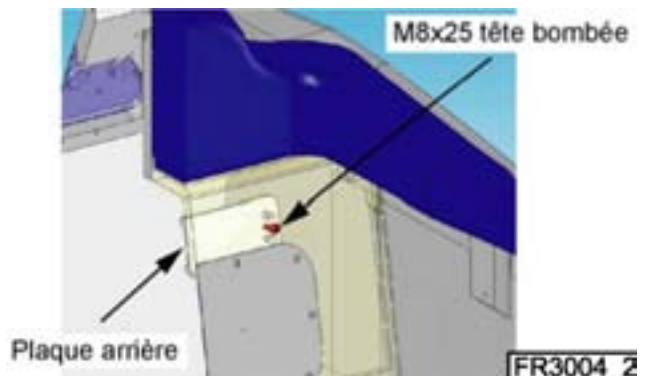
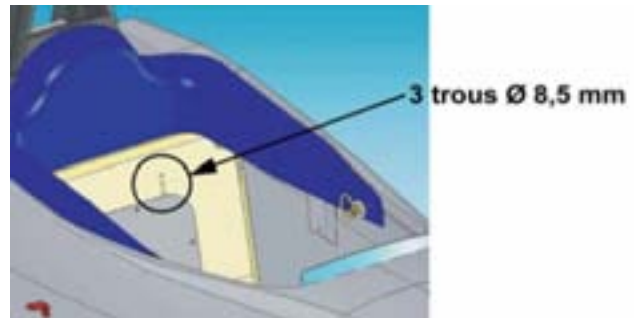

ADJUSTMENT OF FASTENING POINTS OF SUSPENSION

Reference system

Suspension geometry is defined by the coordinates of the points in space.

The X, Y and Z reference axis system is defined as follows.

- X: represents longitudinal axis (car's direction of motion) going through centre of vehicle and having as origin the axis going through the point of contact with the ground of the wheels in the same axle assembly.
- Y: represents transversal axis (towards exterior) and having as origin the longitudinal axis going through the wheel's point of contact with the ground.
- Z: represents the vertical axis (upwards) having the transversal axis with the ground as origin.

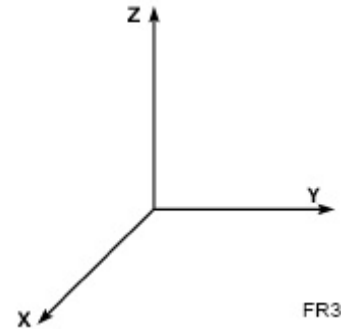

DEFINITION OF SUSPENSION POINTS

Front axle assembly

| POINT | DÉFINITION |
|-------|--|
| 1 | Bottom Suspension wishbone, wheel side |
| 3 | Top Suspension wishbone, wheel side |
| 5 | Alignment bar, wheel side |
| 6 | Push-rod, wheel side |
| 8 | Right end of anti roll axis |
| 9 | Left end of anti roll axis |
| 13 | Point of attachment of damper on ON/OFF |
| 14 | Front attachment, bottom Suspension wishbone, chassis side |
| 15 | Rear attachment, bottom Suspension wishbone, chassis side |
| 16 | Front attachment, top Suspension wishbone, chassis side |
| 17 | Rear attachment, top Suspension wishbone, chassis side |
| 18 | Alignment bar, gear rack side |
| 19 | Push-rod, ON/OFF switch side |
| 20 | Wheel centre |
| 26 | Point of attachment of damper on chassis |

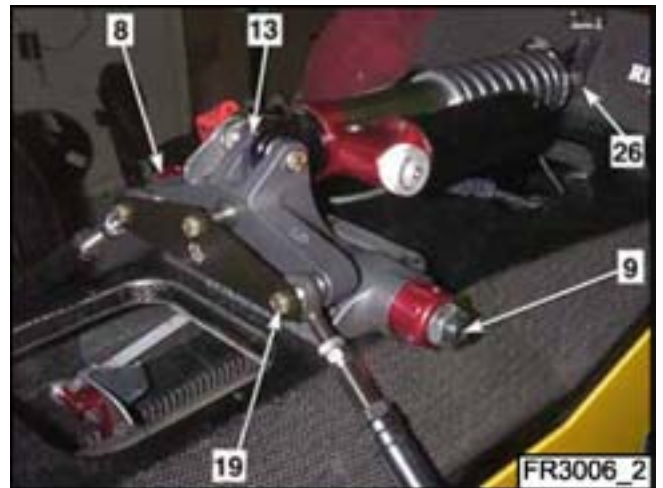

CHASSIS

Suspension fastening points

30

Rear axle assembly

| POINT | DÉFINITION |
|-------|--|
| 1 | Bottom Suspension wishbone, wheel side |
| 3 | Top Suspension wishbone, wheel side |
| 5 | Alignment bar, wheel side |
| 6 | Push-rod, wheel side |
| 8 | Bottom point, ON/OFF switch pivot axis |
| 9 | Top point, ON/OFF switch pivot axis |
| 13 | switch Point of attachment of damper on ON/OFF |
| 14 | Front attachment, bottom Suspension wishbone, gearbox side |
| 15 | Rear attachment, bottom Suspension wishbone, gearbox side |
| 16 | Front attachment, top Suspension wishbone, gearbox side |
| 17 | Rear attachment, top Suspension wishbone, gearbox side |
| 18 | Alignment bar, gearbox side |
| 19 | Push-rod, ON/OFF switch side |
| 20 | Wheel centre |
| 26 | Rear point of attachment of damper |

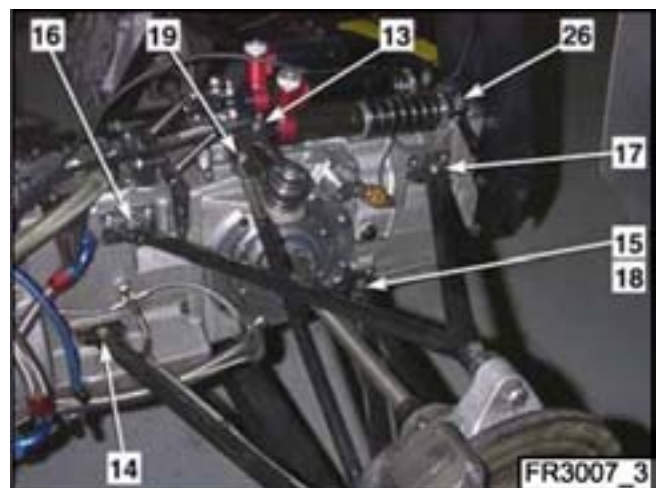
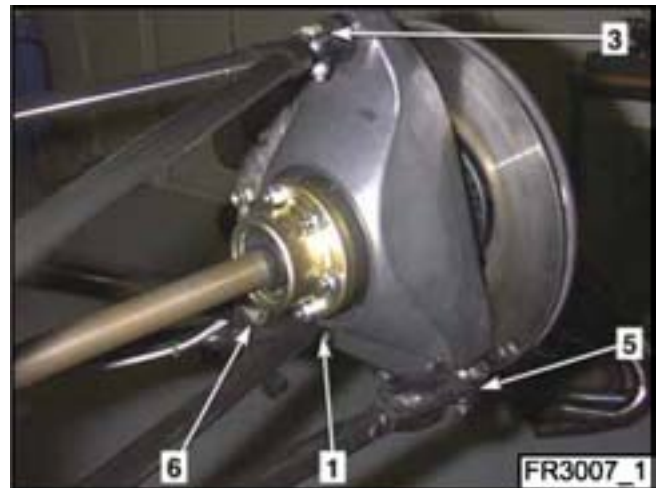

LOCATION OF REAR SUSPENSION FASTENING POINTS

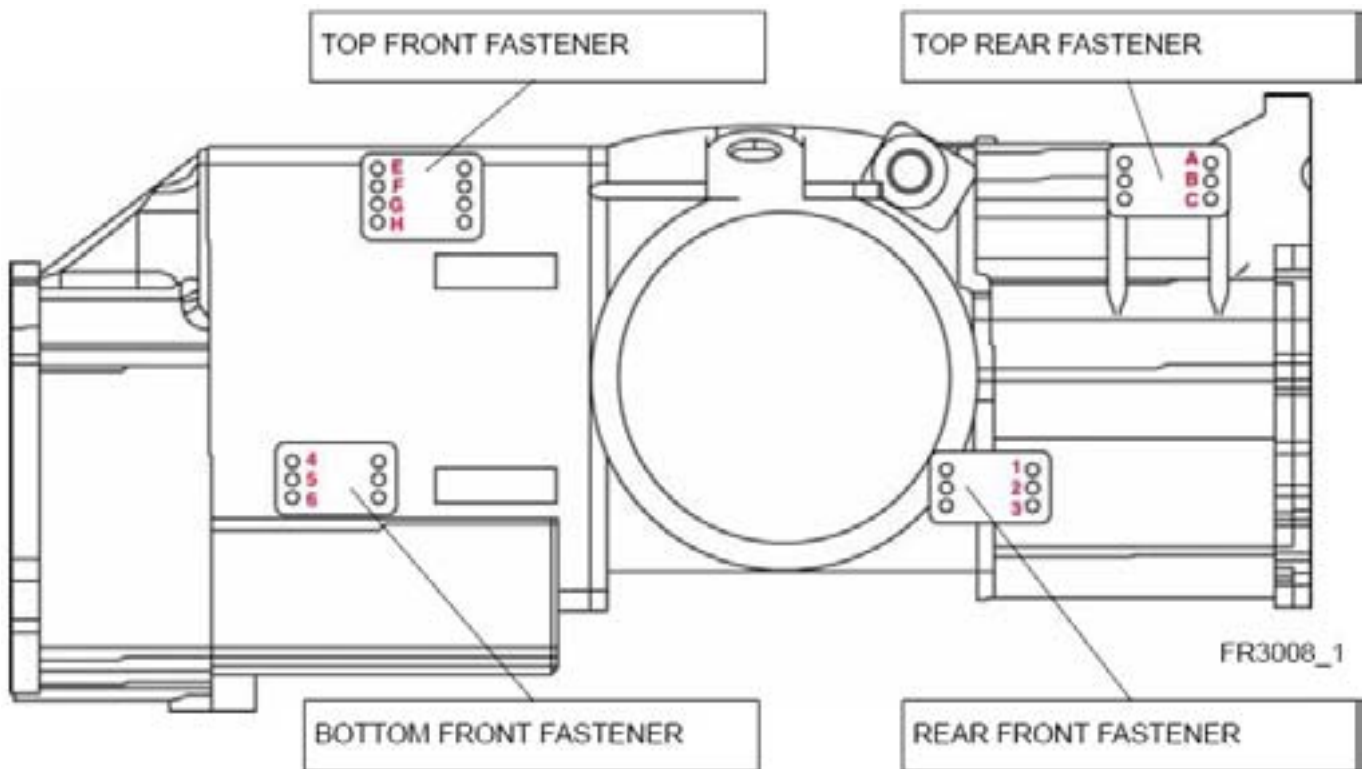

IMPORTANT: There should not be more than one notch of a difference between the front and rear fastening points. Examples: Front point 4 only authorizes rear points 1 and 2; Front point E only authorizes rear points A and B.

Definition of position of Suspension wishbones

Example: 3 5 C H

| | | | |
|--|---|---|---|
| 3 | 5 | C | H |
| | | | Top front fastener (bottom position) |
| | | | Top rear fastener (bottom position) |
| | | | Bottom front fastener (middle position) |
| | | | |
| Bottom rear fastener (bottom position) | | | |

ABBREVIATIONS USED IN TABLES

| | | |
|------------------|---|---|
| Wheel deflect. | : | Wheel deflection |
| Camb. | : | Camber |
| Align. | : | Alignment |
| CR | : | Roll centre |
| Spr. L. | : | Spring length |
| Motion Ratio | : | Wheel deflection in relation to spring movement |
| Variat. Wbase | : | Variation in Wheelbase |
| V. In-Tr width | : | Variation in-track width |
| Wheel Castor | : | Wheel castor |
| C.gyrat Rotat. | : | Centre of gyration/rotation |
| Rim/w offset | : | Rim/wheel offset |
| C. trail/ offset | : | Caster trail/offset |

CHASSIS

Suspension adjustment Tables

30

FRONT AXLE ASSEMBLY

Position of Suspension wishbones: STANDARD

| | |
|---|----------|
| Loaded wheel/tyre assembly radius | 263.99mm |
| Initial setting | |
| - Camber | - 5° |
| - Alignment | - 0.2° |
| - body height (height between pads and ground): | |
| •Front | 25mm |
| •Rear | 35mm |

Position of actual suspension point (in mm)

| Point | Definition | X | Y | Z |
|-------|--|-----------|-----------|---------|
| 1 | Bottom Suspension wishbone, wheel side | 6.680 | 653.120 | 150.860 |
| 3 | Top Suspension wishbone, wheel side | - 10.000 | 594.150 | 363.050 |
| 5 | Alignment bar, wheel side | 82.000 | 622.040 | 365.490 |
| 6 | Push-rod, wheel side | - 0.560 | 594.040 | 175.350 |
| 8 | Right end of antiroll axis | - 106.140 | - 134.380 | 530.420 |
| 9 | Left end of antiroll axis | - 106.140 | 134.380 | 530.420 |
| 13 | Damper fastening point on tipper | - 95.440 | 0.000 | 598.570 |
| 14 | Front fastener, bottom Suspension wishbone, chassis side | 181.190 | 51.500 | 143.710 |
| 15 | Rear fastener, bottom Suspension wishbone, chassis side | - 319.160 | 198.120 | 166.910 |
| 16 | Front fastener, top Suspension wishbone, chassis side | 103.000 | 188.690 | 315.660 |
| 17 | Rear fastener, top Suspension wishbone, chassis side | - 246.600 | 193.660 | 327.260 |
| 18 | Alignment bar, gear rack side | 188.250 | 186.200 | 317.230 |
| 19 | Push-rod, tipper side | - 45.730 | 77.430 | 550.770 |
| 20 | Wheel centre | 0.000 | 694.250 | 263.990 |
| 26 | Damper fastening point on chassis | -416.950 | 0.000 | 574.110 |

| Wheel deflec. mm | Camb. degree | Align. degree | CR mm | Spr. I. mm | Motion ratio | Variat. Wbase mm | V. In-Tr width mm | Wheel castor degree | C.gyrat Rotat. degree | Rim/w offset mm | C. trail /offset mm |
|------------------|--------------|---------------|-------|------------|--------------|------------------|-------------------|---------------------|-----------------------|-----------------|---------------------|
| -30.00 | -4.22 | -0.16 | 83.59 | 348.51 | 1.308 | -1.18 | -2.88 | 4.29 | 14.75 | 22.41 | 17.58 |
| -25.00 | -4.34 | -0.16 | 78.59 | 344.58 | 1.256 | -0.96 | -2.31 | 4.34 | 14.87 | 22.42 | 17.76 |
| -20.00 | -4.47 | -0.17 | 73.60 | 340.50 | 1.207 | -0.76 | -1.78 | 4.37 | 15.00 | 22.43 | 17.93 |
| -15.00 | -4.60 | -0.17 | 68.62 | 336.25 | 1.160 | -0.55 | -1.28 | 4.41 | 15.13 | 22.45 | 18.08 |
| -10.00 | -4.73 | -0.18 | 63.65 | 331.83 | 1.115 | -0.36 | -0.82 | 4.44 | 15.26 | 22.46 | 18.22 |
| -5.00 | -4.86 | -0.19 | 58.69 | 327.23 | 1.071 | -0.18 | -0.39 | 4.47 | 15.39 | 22.48 | 18.35 |
| 0.00 | -5.00 | -0.20 | 53.74 | 322.44 | 1.029 | 0.00 | 0.00 | 4.49 | 15.53 | 22.49 | 18.46 |
| 5.00 | -5.14 | -0.21 | 48.81 | 317.45 | 0.988 | 0.17 | 0.36 | 4.52 | 15.67 | 22.51 | 18.56 |
| 10.00 | -5.29 | -0.22 | 43.88 | 312.26 | 0.948 | 0.33 | 0.68 | 4.54 | 15.82 | 22.52 | 18.65 |
| 15.00 | -5.43 | -0.24 | 38.96 | 306.86 | 0.910 | 0.48 | 0.97 | 4.55 | 15.96 | 22.54 | 18.72 |
| 20.00 | -5.58 | -0.25 | 34.06 | 301.22 | 0.872 | 0.62 | 1.22 | 4.57 | 16.12 | 22.56 | 18.78 |
| 25.00 | -5.74 | -0.27 | 29.16 | 295.34 | 0.836 | 0.76 | 1.44 | 4.58 | 16.27 | 22.58 | 18.83 |
| 30.00 | -5.90 | -0.29 | 24.28 | 289.20 | 0.800 | 0.88 | 1.63 | 4.59 | 16.43 | 22.59 | 18.87 |

| | |
|---------------------------|---------|
| 100% anti-dive angle | 12,437° |
| Effective anti-dive angle | 3,341° |
| Anti-dive | 26,472% |

CHASSIS

Suspension adjustment Tables

30

REAR AXLE ASSEMBLY

Position of Suspension wishbones: 35CH (basic setup)

| | |
|---|----------|
| Loaded wheel/tyre assembly radius | 283.92mm |
| Initial setting | |
| - Camber | - 5° |
| - Alignment | 0° |
| - body height (height between pads and ground): | |
| • Front | 25mm |
| • Rear | 35mm |

Position of actual suspension point (in mm)

| Point | Definition | X | Y | Z |
|-------|--|----------|---------|---------|
| 1 | Bottom Suspension wishbone, wheel side | 77.880 | 587.570 | 180.530 |
| 3 | Top Suspension wishbone, wheel side | -5.900 | 516.350 | 409.310 |
| 5 | Alignment bar, wheel side | - 69.160 | 583.780 | 170.130 |
| 6 | Push-rod, wheel side | 76.660 | 507.590 | 200.510 |
| 8 | Bottom point, tipper pivot axis | 21.900 | 125.030 | 355.640 |
| 9 | Top point, tipper pivot axis | 21.900 | 149.430 | 410.460 |
| 13 | Damper fastening point on tipper | 21.900 | 45.250 | 407.580 |
| 14 | Front fastener, bottom Suspension wishbone, gearbox side | 264.300 | 105.500 | 178.500 |
| 15 | Rear fastener, bottom Suspension wishbone, gearbox side | -110.490 | 105.500 | 152.300 |
| 16 | Front fastener, top Suspension wishbone, gearbox side | 214.300 | 106.440 | 318.080 |
| 17 | Rear fastener, top Suspension wishbone, gearbox side | -214.300 | 106.440 | 330.470 |
| 18 | Alignment bar, gear rack side | -110.490 | 105.500 | 152.300 |
| 19 | Push-rod, tipper side | 63.800 | 87.410 | 388.810 |
| 20 | Wheel centre | 0.000 | 634.730 | 283.920 |
| 26 | Rear damper fastening point | -297.970 | 47.630 | 390.340 |

| Wheel deflec. mm | Camb. degree | Align. degree | CR mm | Spr. I. mm | Motion ratio | Variat. Wbase mm | V In-Tr width mm | Wheel castor degree | C.gyra Rotat. degree | Rim/w offset mm | C. trail /offset mm |
|------------------|--------------|---------------|-------|------------|--------------|------------------|------------------|---------------------|----------------------|-----------------|---------------------|
| -30.00 | -3.91 | 0.06 | 91.50 | 342.02 | 1.567 | -0.81 | -3.21 | 20.68 | 16.20 | 15.84 | 147.61 |
| -25.00 | -4.08 | 0.06 | 85.83 | 338.75 | 1.512 | -0.68 | -2.57 | 20.59 | 16.38 | 15.87 | 146.93 |
| -20.00 | -4.26 | 0.05 | 80.16 | 335.36 | 1.457 | -0.55 | -1.97 | 20.49 | 16.56 | 15.91 | 146.25 |
| -15.00 | -4.45 | 0.04 | 74.50 | 331.84 | 1.401 | -0.41 | -1.42 | 20.40 | 16.74 | 15.95 | 145.58 |
| -10.00 | -4.63 | 0.03 | 68.84 | 328.17 | 1.344 | -0.28 | -0.90 | 20.30 | 16.92 | 15.98 | 144.92 |
| -5.00 | -4.81 | 0.02 | 63.19 | 324.34 | 1.286 | -0.14 | -0.43 | 20.21 | 17.11 | 16.01 | 144.25 |
| 0.00 | -5.00 | 0.00 | 57.55 | 320.34 | 1.227 | 0.00 | 0.00 | 20.11 | 17.29 | 16.04 | 143.59 |
| 5.00 | -5.19 | -0.02 | 51.91 | 316.14 | 1.166 | 0.14 | 0.39 | 20.02 | 17.48 | 16.07 | 142.94 |
| 10.00 | -5.38 | -0.04 | 46.27 | 311.71 | 1.104 | 0.29 | 0.73 | 19.93 | 17.67 | 16.10 | 142.29 |
| 15.00 | -5.57 | -0.06 | 40.64 | 307.02 | 1.039 | 0.43 | 1.04 | 19.83 | 17.86 | 16.13 | 141.65 |
| 20.00 | -5.76 | -0.09 | 35.01 | 302.01 | 0.970 | 0.58 | 1.30 | 19.74 | 18.05 | 16.16 | 141.01 |
| 25.00 | -5.96 | -0.11 | 29.39 | 296.63 | 0.897 | 0.73 | 1.52 | 19.65 | 18.25 | 16.18 | 140.37 |
| 30.00 | -6.15 | -0.14 | 23.77 | 290.77 | 0.817 | 0.88 | 1.70 | 19.56 | 18.44 | 16.21 | 139.74 |

| | |
|----------------------------------|------|
| Wheelbase (mm) | 2645 |
| Height of centre of gravity (mm) | 340 |

| | |
|--------------------------|---------|
| 100% anti-squat angle | 17,815° |
| Effect. Anti-squat angle | 9,435° |
| Anti-squat | 51,710% |

| | |
|---------------------------|---------|
| 100% anti-dive angle | 7,325° |
| Effective anti-dive angle | -0,265° |
| Anti-dive | -3,602% |

CHASSIS

Suspension adjustment Tables

30

REAR AXLE ASSEMBLY

Position of Suspension wishbones: 35 CG

| | |
|---|----------|
| Loaded wheel/tyre assembly radius | 283,92mm |
| Initial setting | |
| - Camber | - 5° |
| - Alignment | 0° |
| - body height (height between pads and ground): | |
| • Front | 25mm |
| • Rear | 35mm |

Position of actual suspension point (in mm)

| Point | Definition | X | Y | Z |
|-------|--|----------|---------|---------|
| 1 | Bottom Suspension wishbone, wheel side | 77.880 | 587.570 | 180.530 |
| 3 | Top Suspension wishbone, wheel side | -5.900 | 516.350 | 409.310 |
| 5 | Alignment bar, wheel side | - 69.160 | 583.780 | 170.130 |
| 6 | Push-rod, wheel side | 76.660 | 507.590 | 200.510 |
| 8 | Bottom point, tipper pivot axis | 21.900 | 125.030 | 355.640 |
| 9 | Top point, tipper pivot axis | 21.900 | 149.430 | 410.460 |
| 13 | Damper fastening point on tipper | 21.900 | 45.250 | 407.580 |
| 14 | Front fastener, bottom Suspension wishbone, gearbox side | 264.300 | 105.500 | 178.500 |
| 15 | Rear fastener, bottom Suspension wishbone, gearbox side | -110.490 | 105.500 | 152.300 |
| 16 | Front fastener, top Suspension wishbone, gearbox side | 214.300 | 106.440 | 328.080 |
| 17 | Rear fastener, top Suspension wishbone, gearbox side | -214.300 | 106.440 | 330.470 |
| 18 | Alignment bar, gear rack side | -110.490 | 105.500 | 152.300 |
| 19 | Push-rod, tipper side | 63.800 | 87.410 | 388.810 |
| 20 | Wheel centre | 0.000 | 634.730 | 283.920 |
| 26 | Rear damper fastening point | -297.970 | 47.630 | 390.340 |

| Wheel deflec. mm | Camb. degree | Align. degree | CR mm | Spr. I. mm | Motion ratio | Variat. Wbase mm | V In-Tr width mm | Wheel castor degree | C.gyra Rotat. degree | Rim/w offset mm | C. trail /offset mm |
|------------------|--------------|---------------|-------|------------|--------------|------------------|------------------|---------------------|----------------------|-----------------|---------------------|
| -30.00 | - 3.96 | 0.06 | 87.04 | 342.23 | 1.554 | - 1.10 | - 3.07 | 20.53 | 16.26 | 15.88 | 146.70 |
| -25.00 | - 4.13 | 0.05 | 81.30 | 338.93 | 1.499 | - 0.92 | - 2.45 | 20.46 | 16.42 | 15.91 | 146.17 |
| -20.00 | - 4.30 | 0.05 | 75.57 | 335.51 | 1.444 | - 0.74 | - 1.87 | 20.39 | 16.59 | 15.94 | 145.65 |
| -15.00 | -4.48 | 0.04 | 69.85 | 331.95 | 1.388 | - 0.56 | - 1.34 | 20.32 | 16.77 | 15.96 | 145.13 |
| -10.00 | - 4.65 | 0.03 | 64.13 | 328.25 | 1.331 | - 0.37 | - 0.85 | 20.25 | 16.94 | 15.99 | 144.62 |
| -5.00 | - 4.82 | 0.01 | 58.42 | 324.39 | 1.273 | - 0.19 | - 0.40 | 20.18 | 17.12 | 16.02 | 144.10 |
| 0.00 | - 5.00 | 0.00 | 52.71 | 320.34 | 1.214 | 0.00 | 0.00 | 20.11 | 17.29 | 16.04 | 143.59 |
| 5.00 | - 5.18 | - 0.02 | 47.01 | 316.09 | 1.154 | 0.19 | 0.36 | 20.04 | 17.47 | 16.07 | 143.09 |
| 10.00 | - 5.36 | - 0.03 | 41.32 | 311.62 | 1.091 | 0.38 | 0.68 | 19.98 | 17.65 | 16.09 | 142.59 |
| 15.00 | - 5.54 | - 0.05 | 35.63 | 306.87 | 1.026 | 0.57 | 0.95 | 19.91 | 17.83 | 16.11 | 142.09 |
| 20.00 | - 5.72 | - 0.08 | 29.95 | 301.80 | 0.957 | 0.77 | 1.19 | 19.84 | 18.01 | 16.13 | 141.59 |
| 25.00 | - 5.91 | - 0.10 | 24.27 | 296.34 | 0.884 | 0.96 | 1.38 | 19.77 | 18.20 | 16.15 | 141.10 |
| 30.00 | - 6.09 | - 0.12 | 18.60 | 290.39 | 0.803 | 1.16 | 1.53 | 19.70 | 18.38 | 16.17 | 140.61 |

| | |
|----------------------------------|------|
| Wheelbase (mm) | 2645 |
| Height of centre of gravity (mm) | 340 |

| | |
|--------------------------|---------|
| 100% anti-squat angle | 17,815° |
| Effect. Anti-squat angle | 8,041° |
| Anti-squat | 43,961% |

| | |
|----------------------------|---------|
| 100% anti-dive angle | 7,325° |
| Effective anti-div e angle | 0,839° |
| Anti-dive | 11,398% |

CHASSIS

Suspension adjustment Tables

30

REAR AXLE ASSEMBLY

Position of Suspension wishbones: 35 BG

| | |
|---|----------|
| Loaded wheel/tyre assembly radius | 283,92mm |
| Initial setting | |
| - Camber | - 5° |
| - Alignment | 0° |
| - body height (height between pads and ground): | |
| • Front | 25mm |
| • Rear | 35mm |

Position of actual suspension point (in mm)

| Point | Definition | X | Y | Z |
|-------|--|----------|---------|---------|
| 1 | Bottom Suspension wishbone, wheel side | 77.880 | 587.570 | 180.530 |
| 3 | Top Suspension wishbone, wheel side | -5.900 | 516.350 | 409.310 |
| 5 | Alignment bar, wheel side | - 69.160 | 583.780 | 170.130 |
| 6 | Push-rod, wheel side | 76.660 | 507.590 | 200.510 |
| 8 | Bottom point, tipper pivot axis | 21.900 | 125.030 | 355.640 |
| 9 | Top point, tipper pivot axis | 21.900 | 149.430 | 410.460 |
| 13 | Damper fastening point on tipper | 21.900 | 45.250 | 407.580 |
| 14 | Front fastener, bottom Suspension wishbone, gearbox side | 264.300 | 105.500 | 178.500 |
| 15 | Rear fastener, bottom Suspension wishbone, gearbox side | -110.490 | 105.500 | 152.300 |
| 16 | Front fastener, top Suspension wishbone, gearbox side | 214.300 | 106.440 | 328.080 |
| 17 | Rear fastener, top Suspension wishbone, gearbox side | -214.300 | 106.440 | 340.470 |
| 18 | Alignment bar, gear rack side | -110.490 | 105.500 | 152.300 |
| 19 | Push-rod, tipper side | 63.800 | 87.410 | 388.810 |
| 20 | Wheel centre | 0.000 | 634.730 | 283.920 |
| 26 | Rear damper fastening point | -297.970 | 47.630 | 390.340 |

| Wheel deflec. mm | Camb. degree | Align. degree | CR mm | Spr. I. mm | Motion ratio | Variat. Wbase mm | V In-Tr width mm | Wheel castor degree | C.gyra Rotat. degree | Rim/w offset mm | C. trail /offset mm |
|------------------|--------------|---------------|-------|------------|--------------|------------------|------------------|---------------------|----------------------|-----------------|---------------------|
| -30.00 | - 4.06 | 0.05 | 81.60 | 342.14 | 1.560 | - 0.79 | - 2.74 | 20.70 | 16.35 | 15.84 | 147.65 |
| -25.00 | - 4.21 | 0.05 | 75.92 | 338.85 | 1.505 | - 0.67 | - 2.17 | 20.60 | 16.50 | 15.87 | 146.96 |
| -20.00 | - 4.37 | 0.04 | 70.25 | 335.45 | 1.450 | - 0.54 | - 1.66 | 20.50 | 16.66 | 15.91 | 146.28 |
| -15.00 | -4.52 | 0.03 | 64.58 | 331.90 | 1.393 | -0.41 | - 1.18 | 20.41 | 16.81 | 15.95 | 145.60 |
| -10.00 | - 4.68 | 0.03 | 58.92 | 328.22 | 1.336 | - 0.27 | - 0.74 | 20.31 | 16.97 | 15.98 | 144.93 |
| -5.00 | - 4.84 | 0.01 | 53.26 | 324.37 | 1.278 | - 0.14 | - 0.35 | 20.21 | 17.13 | 16.01 | 144.26 |
| 0.00 | - 5.00 | 0.00 | 47.61 | 320.34 | 1.219 | 0.00 | 0.00 | 20.11 | 17.29 | 16.04 | 143.59 |
| 5.00 | -5.16 | -0.02 | 41.96 | 316.11 | 1.159 | 0.14 | 0.31 | 20.02 | 17.45 | 16.07 | 142.94 |
| 10.00 | - 5.33 | - 0.04 | 36.32 | 311.65 | 1.096 | 0.28 | 0.58 | 19.92 | 17.62 | 16.10 | 142.28 |
| 15.00 | - 5.49 | - 0.06 | 30.68 | 306.92 | 1.031 | 0.43 | 0.80 | 19.82 | 17.79 | 16.13 | 141.63 |
| 20.00 | - 5.66 | - 0.08 | 25.05 | 301.88 | 0.962 | 0.57 | 0.99 | 19.73 | 17.95 | 16.15 | 140.99 |
| 25.00 | - 5.83 | - 0.10 | 19.42 | 296.45 | 0.888 | 0.72 | 1.13 | 19.63 | 18.12 | 16.18 | 140.35 |
| 30.00 | - 6.00 | - 0.13 | 13.79 | 290.53 | 0.808 | 0.87 | 1.23 | 19.54 | 18.30 | 16.20 | 139.73 |

| | |
|----------------------------------|------|
| Wheelbase (mm) | 2645 |
| Height of centre of gravity (mm) | 340 |

| | |
|--------------------------|---------|
| 100% anti-squat angle | 17,815° |
| Effect. Anti-squat angle | 9,127° |
| Anti-squat | 49,991% |

| | |
|----------------------------|---------|
| 100% anti-dive angle | 7,325° |
| Effective anti-div e angle | -0,020° |
| Anti-dive | -0,275% |

CHASSIS

Suspension adjustment Tables

30

REAR AXLE ASSEMBLY

Position of Suspension wishbones: 35 BF

| | |
|---|----------|
| Loaded wheel/tyre assembly radius | 283,92mm |
| Initial setting | |
| - Camber | - 5° |
| - Alignment | 0° |
| - body height (height between pads and ground): | |
| •Front | 25mm |
| • Rear | 35mm |

Position of actual suspension point (in mm)

| Point | Definition | X | Y | Z |
|-------|--|----------|---------|---------|
| 1 | Bottom Suspension wishbone, wheel side | 77.880 | 587.570 | 180.530 |
| 3 | Top Suspension wishbone, wheel side | -5.900 | 516.350 | 409.310 |
| 5 | Alignment bar, wheel side | - 69.160 | 583.780 | 170.130 |
| 6 | Push-rod, wheel side | 76.660 | 507.590 | 200.510 |
| 8 | Bottom point, tipper pivot axis | 21.900 | 125.030 | 355.640 |
| 9 | Top point, tipper pivot axis | 21.900 | 149.430 | 410.460 |
| 13 | Damper fastening point on tipper | 21.900 | 45.250 | 407.580 |
| 14 | Front fastener, bottom Suspension wishbone, gearbox side | 264.300 | 105.500 | 178.500 |
| 15 | Rear fastener, bottom Suspension wishbone, gearbox side | -110.490 | 105.500 | 152.300 |
| 16 | Front fastener, top Suspension wishbone, gearbox side | 214.300 | 106.440 | 338.080 |
| 17 | Rear fastener, top Suspension wishbone, gearbox side | -214.300 | 106.440 | 340.470 |
| 18 | Alignment bar, gear rack side | -110.490 | 105.500 | 152.300 |
| 19 | Push-rod, tipper side | 63.800 | 87.410 | 388.810 |
| 20 | Wheel centre | 0.000 | 634.730 | 283.920 |
| 26 | Rear damper fastening point | -297.970 | 47.630 | 390.340 |

| Wheel deflec. mm | Camb. degree | Align. degree | CR mm | Spr. I. mm | Motion ratio | Variat. Wbase mm | V In-Tr width mm | Wheel castor degree | C.gyra Rotat. degree | Rim/w offset mm | C. trail /offset mm |
|------------------|--------------|---------------|-------|------------|--------------|------------------|------------------|---------------------|----------------------|-----------------|---------------------|
| -30.00 | - 4.12 | 0.05 | 77.03 | 342.35 | 1.547 | - 1.09 | - 2.59 | 20.55 | 16.41 | 15.88 | 146.72 |
| -25.00 | - 4.26 | 0.04 | 71.29 | 339.03 | 1.492 | - 0.91 | - 2.05 | 20.48 | 16.55 | 15.91 | 146.19 |
| -20.00 | -4.41 | 0.04 | 65.55 | 335.59 | 1.437 | -0.73 | - 1.55 | 20.40 | 16.70 | 15.94 | 145.67 |
| -15.00 | - 4.55 | 0.03 | 59.82 | 332.02 | 1.380 | - 0.55 | - 1.10 | 20.33 | 16.84 | 15.97 | 145.14 |
| -10.00 | - 4.70 | 0.02 | 54.09 | 328.30 | 1.324 | - 0.37 | - 0.69 | 20.26 | 16.99 | 15.99 | 144.62 |
| -5.00 | - 4.85 | 0.01 | 48.37 | 324.41 | 1.266 | - 0.19 | - 0.32 | 20.19 | 17.14 | 16.02 | 144.11 |
| 0.00 | - 5.00 | 0.00 | 42.65 | 320.34 | 1.206 | 0.00 | 0.00 | 20.11 | 17.29 | 16.04 | 143.59 |
| 5.00 | - 5.15 | - 0.01 | 36.94 | 316.07 | 1.146 | 0.19 | 0.28 | 20.04 | 17.44 | 16.07 | 143.09 |
| 10.00 | - 5.31 | - 0.03 | 31.23 | 311.56 | 1.083 | 0.38 | 0.52 | 19.97 | 17.60 | 16.09 | 142.58 |
| 15.00 | - 5.46 | - 0.05 | 25.53 | 306.77 | 1.018 | 0.57 | 0.72 | 19.90 | 17.75 | 16.11 | 142.08 |
| 20.00 | - 5.62 | - 0.07 | 19.83 | 301.66 | 0.919 | 0.76 | 0.87 | 19.83 | 17.91 | 16.13 | 141.58 |
| 25.00 | - 5.78 | - 0.09 | 14.14 | 296.16 | 0.875 | 0.96 | 0.98 | 19.75 | 18.07 | 16.15 | 141.08 |
| 30.00 | - 5.94 | - 0.11 | 8.46 | 290.14 | 0.794 | 1.15 | 1.05 | 19.68 | 18.23 | 16.17 | 140.59 |

| | |
|----------------------------------|------|
| Wheelbase (mm) | 2645 |
| Height of centre of gravity (mm) | 340 |

| | |
|--------------------------|---------|
| 100% anti-squat angle | 17,815° |
| Effect. Anti-squat angle | 7,817° |
| Anti-squat | 42,722% |

| | |
|----------------------------|---------|
| 100% anti-dive angle | 7,325° |
| Effective anti-div e angle | 1,016° |
| Anti-dive | 13,796% |

CHASSIS

Suspension adjustment Tables

30

REAR AXLE ASSEMBLY

Position of Suspension wishbones: 35 AF

| | |
|---|----------|
| Loaded wheel/tyre assembly radius | 283,92mm |
| Initial setting | |
| - Camber | - 5° |
| - Alignment | 0° |
| - body height (height between pads and ground): | |
| •Front | 25mm |
| • Rear | 35mm |

Position of actual suspension point (in mm)

| Point | Definition | X | Y | Z |
|-------|--|----------|---------|---------|
| 1 | Bottom Suspension wishbone, wheel side | 77.880 | 587.570 | 180.530 |
| 3 | Top Suspension wishbone, wheel side | -5.900 | 516.350 | 409.310 |
| 5 | Alignment bar, wheel side | - 69.160 | 583.780 | 170.130 |
| 6 | Push-rod, wheel side | 76.660 | 507.590 | 200.510 |
| 8 | Bottom point, tipper pivot axis | 21.900 | 125.030 | 355.640 |
| 9 | Top point, tipper pivot axis | 21.900 | 149.430 | 410.460 |
| 13 | Damper fastening point on tipper | 21.900 | 45.250 | 407.580 |
| 14 | Front fastener, bottom Suspension wishbone, gearbox side | 264.300 | 105.500 | 178.500 |
| 15 | Rear fastener, bottom Suspension wishbone, gearbox side | -110.490 | 105.500 | 152.300 |
| 16 | Front fastener, top Suspension wishbone, gearbox side | 214.300 | 106.440 | 338.080 |
| 17 | Rear fastener, top Suspension wishbone, gearbox side | -214.300 | 106.440 | 350.470 |
| 18 | Alignment bar, gear rack side | -110.490 | 105.500 | 152.300 |
| 19 | Push-rod, tipper side | 63.800 | 87.410 | 388.810 |
| 20 | Wheel centre | 0.000 | 634.730 | 283.920 |
| 26 | Rear damper fastening point | -297.970 | 47.630 | 390.340 |

| Wheel deflec. mm | Camb. degree | Align. degree | CR mm | Spr. I. mm | Motion ratio | Variat. Wbase mm | V In-Tr width mm | Wheel castor degree | C.gyra Rotat. degree | Rim/w offset mm | C. trail /offset mm |
|------------------|--------------|---------------|-------|------------|--------------|------------------|------------------|---------------------|----------------------|-----------------|---------------------|
| -30.00 | -4.22 | 0.04 | 71.40 | 342.26 | 1.553 | - 0.78 | - 2.25 | 20.72 | 16.51 | 15.84 | 147.69 |
| -25.00 | - 4.34 | 0.04 | 65.73 | 338.96 | 1.498 | - 0.65 | - 1.77 | 20.62 | 16.64 | 15.87 | 146.99 |
| -20.00 | - 4.47 | 0.03 | 60.06 | 335.53 | 1.442 | - 0.53 | - 1.33 | 20.52 | 16.76 | 15.91 | 146.30 |
| -15.00 | - 4.60 | 0.03 | 54.39 | 331.97 | 1.386 | - 0.40 | - 0.93 | 20.42 | 16.89 | 15.95 | 145.62 |
| -10.00 | - 4.73 | 0.02 | 48.72 | 328.27 | 1.329 | - 0.27 | - 0.58 | 20.31 | 17.02 | 15.98 | 144.94 |
| -5.00 | - 4.87 | 0.01 | 43.06 | 324.39 | 1.271 | - 0.14 | - 0.27 | 20.21 | 17.16 | 16.01 | 144.26 |
| 0.00 | - 5.00 | 0.00 | 37.41 | 320.34 | 1.211 | 0.00 | 0.00 | 20.11 | 17.29 | 16.04 | 143.59 |
| 5.00 | -5.14 | -0.01 | 31.75 | 316.08 | 1.151 | 0.14 | 0.23 | 20.01 | 17.43 | 16.07 | 142.93 |
| 10.00 | - 5.28 | - 0.03 | 26.10 | 311.59 | 1.088 | 0.28 | 0.41 | 19.91 | 17.57 | 16.10 | 142.27 |
| 15.00 | - 5.42 | - 0.05 | 20.46 | 306.83 | 1.022 | 0.42 | 0.56 | 19.81 | 17.71 | 16.12 | 141.62 |
| 20.00 | - 5.56 | - 0.07 | 14.81 | 301.74 | 0.954 | 0.57 | 0.66 | 19.71 | 17.85 | 16.15 | 140.96 |
| 25.00 | - 5.70 | - 0.10 | 9.18 | 296.27 | 0.880 | 0.71 | 0.72 | 19.61 | 18.00 | 16.17 | 140.32 |
| 30.00 | - 5.85 | - 0.12 | 3.54 | 290.28 | 0.799 | 0.86 | 0.74 | 19.51 | 18.14 | 16.19 | 139.68 |

| | |
|----------------------------------|------|
| Wheelbase (mm) | 2645 |
| Height of centre of gravity (mm) | 340 |

| | |
|--------------------------|---------|
| 100% anti-squat angle | 17,815° |
| Effect. Anti-squat angle | 8,851° |
| Anti-squat | 48,458% |

| | |
|----------------------------|--------|
| 100% anti-dive angle | 7,325° |
| Effective anti-div e angle | 0,198° |
| Anti-dive | 2,692% |

CHASSIS

Suspension adjustment Tables

30

REAR AXLE ASSEMBLY

Position of Suspension wishbones: 35 AE

| | |
|---|----------|
| Loaded wheel/tyre assembly radius | 283,92mm |
| Initial setting | |
| - Camber | - 5° |
| - Alignment | 0° |
| - body height (height between pads and ground): | |
| •Front | 25mm |
| •Rear | 35mm |

Position of actual suspension point (in mm)

| Point | Definition | X | Y | Z |
|-------|--|----------|---------|---------|
| 1 | Bottom Suspension wishbone, wheel side | 77.880 | 587.570 | 180.530 |
| 3 | Top Suspension wishbone, wheel side | -5.900 | 516.350 | 409.310 |
| 5 | Alignment bar, wheel side | - 69.160 | 583.780 | 170.130 |
| 6 | Push-rod, wheel side | 76.660 | 507.590 | 200.510 |
| 8 | Bottom point, tipper pivot axis | 21.900 | 125.030 | 355.640 |
| 9 | Top point, tipper pivot axis | 21.900 | 149.430 | 410.460 |
| 13 | Damper fastening point on tipper | 21.900 | 45.250 | 407.580 |
| 14 | Front fastener, bottom Suspension wishbone, gearbox side | 264.300 | 105.500 | 178.500 |
| 15 | Rear fastener, bottom Suspension wishbone, gearbox side | -110.490 | 105.500 | 152.300 |
| 16 | Front fastener, top Suspension wishbone, gearbox side | 214.300 | 106.440 | 348.080 |
| 17 | Rear fastener, top Suspension wishbone, gearbox side | -214.300 | 106.440 | 350.470 |
| 18 | Alignment bar, gear rack side | -110.490 | 105.500 | 152.300 |
| 19 | Push-rod, tipper side | 63.800 | 87.410 | 388.810 |
| 20 | Wheel centre | 0.000 | 634.730 | 283.920 |
| 26 | Rear damper fastening point | -297.970 | 47.630 | 390.340 |

| Wheel deflec. mm | Camb. degree | Align. degree | CR mm | Spr. I. mm | Motion ratio | Variat. Wbase mm | V In-Tr width mm | Wheel castor degree | C.gyra Rotat. degree | Rim/w offset mm | C. trail /offset mm |
|------------------|--------------|---------------|--------|------------|--------------|------------------|------------------|---------------------|----------------------|-----------------|---------------------|
| -30.00 | - 4.28 | 0.04 | 66.74 | 342.47 | 1.540 | - 1.08 | - 2.09 | 20.57 | 16.57 | 15.88 | 146.75 |
| -25.00 | - 4.40 | 0.03 | 60.99 | 339.14 | 1.485 | - 0.90 | - 1.64 | 20.49 | 16.69 | 15.91 | 146.22 |
| -20.00 | - 4.51 | 0.03 | 55.24 | 335.68 | 1.429 | - 0.73 | - 1.22 | 20.42 | 16.80 | 15.94 | 145.68 |
| -15.00 | -4.63 | 0.03 | 49.50 | 332.09 | 1.373 | - 0.55 | - 0.85 | 20.34 | 16.92 | 15.97 | 145.16 |
| -10.00 | - 4.75 | 0.02 | 43.77 | 328.35 | 1.316 | - 0.37 | - 0.53 | 20.26 | 17.04 | 15.99 | 144.63 |
| -5.00 | - 4.88 | 0.01 | 38.04 | 324.44 | 1.258 | - 0.18 | - 0.24 | 20.19 | 17.17 | 16.02 | 144.11 |
| 0.00 | - 5.00 | 0.00 | 32.31 | 320.34 | 1.199 | 0.00 | 0.00 | 20.11 | 17.29 | 16.04 | 143.59 |
| 5.00 | - 5.13 | - 0.01 | 26.59 | 316.04 | 1.138 | 0.19 | 0.20 | 20.04 | 17.42 | 16.06 | 143.08 |
| 10.00 | - 5.25 | - 0.03 | 20.87 | 311.49 | 1.075 | 0.37 | 0.36 | 19.96 | 17.55 | 16.09 | 142.57 |
| 15.00 | - 5.39 | - 0.04 | 15.16 | 306.67 | 1.010 | 0.57 | 0.47 | 19.89 | 17.68 | 16.11 | 142.07 |
| 20.00 | - 5.52 | - 0.06 | 9.45 | 301.52 | 0.941 | 0.76 | 0.54 | 19.81 | 17.81 | 16.13 | 141.56 |
| 25.00 | - 5.65 | - 0.08 | 3.75 | 295.96 | 0.867 | 0.95 | 0.57 | 19.74 | 17.94 | 16.15 | 141.06 |
| 30.00 | - 5.79 | - 0.10 | - 1.95 | 289.89 | 0.785 | 1.15 | 0.56 | 19.66 | 18.08 | 16.16 | 140.57 |

| | |
|----------------------------------|------|
| Wheelbase (mm) | 2645 |
| Height of centre of gravity (mm) | 340 |

| | |
|--------------------------|---------|
| 100% anti-squat angle | 17,815° |
| Effect. Anti-squat angle | 7,617° |
| Anti-squat | 41,614% |

| | |
|---------------------------|---------|
| 100% anti-dive angle | 7,325° |
| Effective anti-dive angle | 1,174° |
| Anti-dive | 15,940% |

CHASSIS

Suspension adjustment Tables

30

REAR AXLE ASSEMBLY

Position of Suspension wishbones: 36 CG

| | |
|---|----------|
| Loaded wheel/tyre assembly radius | 283,92mm |
| Initial setting | |
| - Camber | - 5° |
| - Alignment | 0° |
| - body height (height between pads and ground): | |
| •Front | 25mm |
| •Rear | 35mm |

Position of actual suspension point (in mm)

| Point | Definition | X | Y | Z |
|-------|--|----------|---------|---------|
| 1 | Bottom Suspension wishbone, wheel side | 77.880 | 587.570 | 180.530 |
| 3 | Top Suspension wishbone, wheel side | -5.900 | 516.350 | 409.310 |
| 5 | Alignment bar, wheel side | - 69.160 | 583.780 | 170.130 |
| 6 | Push-rod, wheel side | 76.660 | 507.590 | 200.510 |
| 8 | Bottom point, tipper pivot axis | 21.900 | 125.030 | 355.640 |
| 9 | Top point, tipper pivot axis | 21.900 | 149.430 | 410.460 |
| 13 | Damper fastening point on tipper | 21.900 | 45.250 | 407.580 |
| 14 | Front fastener, bottom Suspension wishbone, gearbox side | 264.300 | 105.500 | 168.500 |
| 15 | Rear fastener, bottom Suspension wishbone, gearbox side | -110.490 | 105.500 | 152.300 |
| 16 | Front fastener, top Suspension wishbone, gearbox side | 214.300 | 106.440 | 328.080 |
| 17 | Rear fastener, top Suspension wishbone, gearbox side | -214.300 | 106.440 | 330.470 |
| 18 | Alignment bar, gear rack side | -110.490 | 105.500 | 152.300 |
| 19 | Push-rod, tipper side | 63.800 | 87.410 | 388.810 |
| 20 | Wheel centre | 0.000 | 634.730 | 283.920 |
| 26 | Rear damper fastening point | -297.970 | 47.630 | 390.340 |

| Wheel deflec. mm | Camb. degree | Align. degree | CR mm | Spr. I. mm | Motion ratio | Variat. Wbase mm | V In-Tr width mm | Wheel castor degree | C.gyra Rotat. degree | Rim/w offset mm | C. trail /offset mm |
|------------------|--------------|---------------|-------|------------|--------------|------------------|------------------|---------------------|----------------------|-----------------|---------------------|
| -30.00 | - 3.96 | 0.06 | 87.04 | 342.23 | 1.554 | - 1.10 | - 3.07 | 20.53 | 16.26 | 15.88 | 146.70 |
| -25.00 | - 4.13 | 0.05 | 81.30 | 338.93 | 1.499 | - 0.92 | - 2.45 | 20.46 | 16.42 | 15.91 | 146.17 |
| -20.00 | - 4.30 | 0.05 | 75.57 | 335.51 | 1.444 | - 0.74 | - 1.87 | 20.39 | 16.59 | 15.94 | 145.65 |
| -15.00 | - 4.48 | 0.04 | 69.85 | 331.95 | 1.388 | - 0.56 | - 1.34 | 20.32 | 16.77 | 15.96 | 145.13 |
| -10.00 | - 4.65 | 0.03 | 64.13 | 328.25 | 1.331 | - 0.37 | - 0.85 | 20.25 | 16.94 | 15.99 | 144.62 |
| -5.00 | - 4.82 | 0.01 | 58.42 | 324.39 | 1.273 | - 0.19 | - 0.40 | 20.18 | 17.12 | 16.02 | 144.10 |
| 0.00 | - 5.00 | 0.00 | 52.71 | 320.34 | 1.214 | 0.00 | 0.00 | 20.11 | 17.29 | 16.04 | 143.59 |
| 5.00 | - 5.18 | - 0.02 | 47.01 | 316.09 | 1.154 | 0.19 | 0.36 | 20.04 | 17.47 | 16.07 | 143.09 |
| 10.00 | - 5.36 | - 0.03 | 41.32 | 311.62 | 1.091 | 0.38 | 0.68 | 19.98 | 17.65 | 16.09 | 142.59 |
| 15.00 | - 5.54 | - 0.05 | 35.63 | 306.87 | 1.026 | 0.57 | 0.95 | 19.91 | 17.83 | 16.11 | 142.09 |
| 20.00 | - 5.72 | - 0.08 | 29.95 | 301.80 | 0.957 | 0.77 | 1.19 | 19.84 | 18.01 | 16.13 | 141.59 |
| 25.00 | - 5.91 | - 0.10 | 24.27 | 296.34 | 0.884 | 0.96 | 1.38 | 19.77 | 18.20 | 16.15 | 141.10 |
| 30.00 | - 6.09 | - 0.12 | 18.60 | 290.39 | 0.803 | 1.16 | 1.53 | 19.70 | 18.38 | 16.17 | 140.61 |

| | |
|----------------------------------|------|
| Wheelbase (mm) | 2645 |
| Height of centre of gravity (mm) | 340 |

| | |
|--------------------------|---------|
| 100% anti-squat angle | 17,815° |
| Effect. Anti-squat angle | 5,014° |
| Anti-squat | 27,302% |

| | |
|----------------------------|--------|
| 100% anti-dive angle | 7,325° |
| Effective anti-div e angle | 0,417° |
| Anti-dive | 5,661% |

CHASSIS

Suspension adjustment Tables

30

REAR AXLE ASSEMBLY

Position of Suspension wishbones: 36 CH

| | |
|---|----------|
| Loaded wheel/tyre assembly radius | 283,92mm |
| Initial setting | |
| - Camber | - 5° |
| - Alignment | 0° |
| - body height (height between pads and ground): | |
| •Front | 25mm |
| • Rear | 35mm |

Position of actual suspension point (in mm)

| Point | Definition | X | Y | Z |
|-------|--|----------|---------|---------|
| 1 | Bottom Suspension wishbone, wheel side | 77.880 | 587.570 | 180.530 |
| 3 | Top Suspension wishbone, wheel side | -5.900 | 516.350 | 409.310 |
| 5 | Alignment bar, wheel side | - 69.160 | 583.780 | 170.130 |
| 6 | Push-rod, wheel side | 76.660 | 507.590 | 200.510 |
| 8 | Bottom point, tipper pivot axis | 21.900 | 125.030 | 355.640 |
| 9 | Top point, tipper pivot axis | 21.900 | 149.430 | 410.460 |
| 13 | Damper fastening point on tipper | 21.900 | 45.250 | 407.580 |
| 14 | Front fastener, bottom Suspension wishbone, gearbox side | 264.300 | 105.500 | 168.500 |
| 15 | Rear fastener, bottom Suspension wishbone, gearbox side | -110.490 | 105.500 | 152.300 |
| 16 | Front fastener, top Suspension wishbone, gearbox side | 214.300 | 106.440 | 318.080 |
| 17 | Rear fastener, top Suspension wishbone, gearbox side | -214.300 | 106.440 | 330.470 |
| 18 | Alignment bar, gear rack side | -110.490 | 105.500 | 152.300 |
| 19 | Push-rod, tipper side | 63.800 | 87.410 | 388.810 |
| 20 | Wheel centre | 0.000 | 634.730 | 283.920 |
| 26 | Rear damper fastening point | -297.970 | 47.630 | 390.340 |

| Wheel deflec. mm | Camb. degree | Align. degree | CR mm | Spr. I. mm | Motion ratio | Variat. Wbase mm | V In-Tr width mm | Wheel castor degree | C.gyra Rotat. degree | Rim/w offset mm | C. trail /offset mm |
|------------------|--------------|---------------|-------|------------|--------------|------------------|------------------|---------------------|----------------------|-----------------|---------------------|
| -30.00 | - 3.96 | 0.06 | 87.04 | 342.23 | 1.554 | - 1.10 | - 3.07 | 20.53 | 16.26 | 15.88 | 146.70 |
| -25.00 | - 4.13 | 0.05 | 81.30 | 338.93 | 1.499 | - 0.92 | - 2.45 | 20.46 | 16.42 | 15.91 | 146.17 |
| -20.00 | - 4.30 | 0.05 | 75.57 | 335.51 | 1.444 | - 0.74 | - 1.87 | 20.39 | 16.59 | 15.94 | 145.65 |
| -15.00 | - 4.48 | 0.04 | 69.85 | 331.95 | 1.388 | - 0.56 | - 1.34 | 20.32 | 16.77 | 15.96 | 145.13 |
| -10.00 | - 4.65 | 0.03 | 64.13 | 328.25 | 1.331 | - 0.37 | - 0.85 | 20.25 | 16.94 | 15.99 | 144.62 |
| -5.00 | - 4.82 | 0.01 | 58.42 | 324.39 | 1.273 | - 0.19 | - 0.40 | 20.18 | 17.12 | 16.02 | 144.10 |
| 0.00 | - 5.00 | 0.00 | 52.71 | 320.34 | 1.214 | 0.00 | 0.00 | 20.11 | 17.29 | 16.04 | 143.59 |
| 5.00 | - 5.18 | - 0.02 | 47.01 | 316.09 | 1.154 | 0.19 | 0.36 | 20.04 | 17.47 | 16.07 | 143.09 |
| 10.00 | - 5.36 | - 0.03 | 41.32 | 311.62 | 1.091 | 0.38 | 0.68 | 19.98 | 17.65 | 16.09 | 142.59 |
| 15.00 | - 5.54 | - 0.05 | 35.63 | 306.87 | 1.026 | 0.57 | 0.95 | 19.91 | 17.83 | 16.11 | 142.09 |
| 20.00 | - 5.72 | - 0.08 | 29.95 | 301.80 | 0.957 | 0.77 | 1.19 | 19.84 | 18.01 | 16.13 | 141.59 |
| 25.00 | - 5.91 | - 0.10 | 24.27 | 296.34 | 0.884 | 0.96 | 1.38 | 19.77 | 18.20 | 16.15 | 141.10 |
| 30.00 | - 6.09 | - 0.12 | 18.60 | 290.39 | 0.803 | 1.16 | 1.53 | 19.70 | 18.38 | 16.17 | 140.61 |

| | |
|----------------------------------|------|
| Wheelbase (mm) | 2645 |
| Height of centre of gravity (mm) | 340 |

| | |
|--------------------------|---------|
| 100% anti-squat angle | 17,815° |
| Effect. Anti-squat angle | 6,333° |
| Anti-squat | 34,537% |

| | |
|---------------------------|---------|
| 100% anti-dive angle | 7,325° |
| Effective anti-dive angle | -0,659° |
| Anti-dive | -8,945% |

CHASSIS

Suspension adjustment Tables

30

REAR AXLE ASSEMBLY

Position of Suspension wishbones: 36 BG

| | |
|---|----------|
| Loaded wheel/tyre assembly radius | 283,92mm |
| Initial setting | |
| - Camber | - 5° |
| - Alignment | 0° |
| - body height (height between pads and ground): | |
| • Front | 25mm |
| • Rear | 35mm |

Position of actual suspension point (in mm)

| Point | Definition | X | Y | Z |
|-------|--|----------|---------|---------|
| 1 | Bottom Suspension wishbone, wheel side | 77.880 | 587.570 | 180.530 |
| 3 | Top Suspension wishbone, wheel side | -5.900 | 516.350 | 409.310 |
| 5 | Alignment bar, wheel side | - 69.160 | 583.780 | 170.130 |
| 6 | Push-rod, wheel side | 76.660 | 507.590 | 200.510 |
| 8 | Bottom point, tipper pivot axis | 21.900 | 125.030 | 355.640 |
| 9 | Top point, tipper pivot axis | 21.900 | 149.430 | 410.460 |
| 13 | Damper fastening point on tipper | 21.900 | 45.250 | 407.580 |
| 14 | Front fastener, bottom Suspension wishbone, gearbox side | 264.300 | 105.500 | 168.500 |
| 15 | Rear fastener, bottom Suspension wishbone, gearbox side | -110.490 | 105.500 | 152.300 |
| 16 | Front fastener, top Suspension wishbone, gearbox side | 214.300 | 106.440 | 328.080 |
| 17 | Rear fastener, top Suspension wishbone, gearbox side | -214.300 | 106.440 | 340.470 |
| 18 | Alignment bar, gear rack side | -110.490 | 105.500 | 152.300 |
| 19 | Push-rod, tipper side | 63.800 | 87.410 | 388.810 |
| 20 | Wheel centre | 0.000 | 634.730 | 283.920 |
| 26 | Rear damper fastening point | -297.970 | 47.630 | 390.340 |

| Wheel deflec. mm | Camb. degree | Align. degree | CR mm | Spr. I. mm | Motion ratio | Variat. Wbase mm | V In-Tr width mm | Wheel castor degree | C.gyra Rotat. degree | Rim/w offset mm | C. trail /offset mm |
|------------------|--------------|---------------|-------|------------|--------------|------------------|------------------|---------------------|----------------------|-----------------|---------------------|
| -30.00 | - 4.11 | - 0.04 | 71.90 | 342.77 | 1.519 | - 0.26 | - 2.38 | 20.53 | 16.40 | 15.81 | 146.71 |
| -25.00 | - 4.26 | - 0.03 | 66.20 | 339.40 | 1.465 | - 0.22 | - 1.88 | 20.46 | 16.55 | 15.85 | 146.18 |
| -20.00 | - 4.40 | - 0.02 | 60.50 | 335.89 | 1.410 | - 0.18 | - 1.42 | 20.39 | 16.69 | 15.89 | 145.66 |
| -15.00 | - 4.55 | - 0.01 | 54.81 | 332.25 | 1.354 | - 0.14 | - 1.00 | 20.32 | 16.84 | 15.93 | 145.14 |
| -10.00 | - 4.70 | - 0.01 | 49.13 | 328.46 | 1.298 | - 0.10 | - 0.62 | 20.25 | 16.99 | 15.97 | 144.62 |
| -5.00 | - 4.85 | 0.00 | 43.45 | 324.49 | 1.241 | - 0.05 | - 0.29 | 20.18 | 17.14 | 16.01 | 144.11 |
| 0.00 | - 5.00 | 0.00 | 37.77 | 320.34 | 1.182 | 0.00 | 0.00 | 20.11 | 17.29 | 16.04 | 143.59 |
| 5.00 | - 5.15 | 0.00 | 32.10 | 315.98 | 1.122 | 0.05 | 0.25 | 20.05 | 17.45 | 16.08 | 143.09 |
| 10.00 | - 5.31 | 0.00 | 26.44 | 311.37 | 1.060 | 0.10 | 0.45 | 19.98 | 17.60 | 16.11 | 142.58 |
| 15.00 | - 5.47 | - 0.01 | 20.78 | 306.48 | 0.996 | 0.16 | 0.62 | 19.91 | 17.76 | 16.15 | 142.08 |
| 20.00 | - 5.63 | - 0.01 | 15.12 | 301.26 | 0.927 | 0.21 | 0.74 | 19.84 | 17.92 | 16.18 | 141.59 |
| 25.00 | - 5.79 | - 0.02 | 9.47 | 295.62 | 0.854 | 0.27 | 0.82 | 19.78 | 18.08 | 16.21 | 141.09 |
| 30.00 | - 5.95 | - 0.03 | 3.82 | 289.45 | 0.773 | 0.33 | 0.86 | 19.71 | 18.24 | 16.24 | 140.60 |

| | |
|----------------------------------|------|
| Wheelbase (mm) | 2645 |
| Height of centre of gravity (mm) | 340 |

| | |
|--------------------------|---------|
| 100% anti-squat angle | 17,815° |
| Effect. Anti-squat angle | 6,117° |
| Anti-squat | 33,347% |

| | |
|----------------------------|---------|
| 100% anti-dive angle | 7,325° |
| Effective anti-div e angle | -0,482° |
| Anti-dive | -6,543% |

CHASSIS

Suspension adjustment Tables

30

REAR AXLE ASSEMBLY

Position of Suspension wishbones: 36 BF

| | |
|---|----------|
| Loaded wheel/tyre assembly radius | 283,92mm |
| Initial setting | |
| - Camber | - 5° |
| - Alignment | 0° |
| - body height (height between pads and ground): | |
| • Front | 25mm |
| • Rear | 35mm |

Position of actual suspension point (in mm)

| Point | Definition | X | Y | Z |
|-------|--|----------|---------|---------|
| 1 | Bottom Suspension wishbone, wheel side | 77.880 | 587.570 | 180.530 |
| 3 | Top Suspension wishbone, wheel side | -5.900 | 516.350 | 409.310 |
| 5 | Alignment bar, wheel side | - 69.160 | 583.780 | 170.130 |
| 6 | Push-rod, wheel side | 76.660 | 507.590 | 200.510 |
| 8 | Bottom point, tipper pivot axis | 21.900 | 125.030 | 355.640 |
| 9 | Top point, tipper pivot axis | 21.900 | 149.430 | 410.460 |
| 13 | Damper fastening point on tipper | 21.900 | 45.250 | 407.580 |
| 14 | Front fastener, bottom Suspension wishbone, gearbox side | 264.300 | 105.500 | 168.500 |
| 15 | Rear fastener, bottom Suspension wishbone, gearbox side | -110.490 | 105.500 | 152.300 |
| 16 | Front fastener, top Suspension wishbone, gearbox side | 214.300 | 106.440 | 338.080 |
| 17 | Rear fastener, top Suspension wishbone, gearbox side | -214.300 | 106.440 | 340.470 |
| 18 | Alignment bar, gear rack side | -110.490 | 105.500 | 152.300 |
| 19 | Push-rod, tipper side | 63.800 | 87.410 | 388.810 |
| 20 | Wheel centre | 0.000 | 634.730 | 283.920 |
| 26 | Rear damper fastening point | -297.970 | 47.630 | 390.340 |

| Wheel deflec. mm | Camb. degree | Align. degree | CR mm | Spr. I. mm | Motion ratio | Variat. Wbase mm | V In-Tr width mm | Wheel castor degree | C.gyra Rotat. degree | Rim/w offset mm | C. trail /offset mm |
|------------------|--------------|---------------|--------|------------|--------------|------------------|------------------|---------------------|----------------------|-----------------|---------------------|
| -30.00 | - 4.17 | - 0.04 | 67.20 | 342.98 | 1.507 | - 0.56 | - 2.23 | 20.37 | 16.46 | 15.85 | 145.78 |
| -25.00 | - 4.31 | - 0.03 | 61.43 | 339.58 | 1.452 | - 0.47 | - 1.75 | 20.33 | 16.60 | 15.88 | 145.41 |
| -20.00 | - 4.44 | - 0.02 | 55.66 | 336.05 | 1.397 | - 0.38 | - 1.31 | 20.29 | 16.73 | 15.92 | 145.04 |
| -15.00 | - 4.58 | - 0.01 | 49.90 | 332.37 | 1.342 | - 0.28 | - 0.92 | 20.24 | 16.87 | 15.95 | 144.68 |
| -10.00 | - 4.72 | - 0.01 | 44.14 | 328.54 | 1.285 | - 0.19 | - 0.57 | 20.20 | 17.01 | 15.98 | 144.31 |
| -5.00 | - 4.86 | 0.00 | 38.39 | 324.54 | 1.228 | - 0.10 | - 0.26 | 20.16 | 17.15 | 16.01 | 143.95 |
| 0.00 | - 5.00 | 0.00 | 32.65 | 320.34 | 1.170 | 0.00 | 0.00 | 20.11 | 17.29 | 16.04 | 143.59 |
| 5.00 | - 5.14 | 0.00 | 26.91 | 315.93 | 1.110 | 0.10 | 0.22 | 20.07 | 17.44 | 16.07 | 143.24 |
| 10.00 | - 5.29 | 0.00 | 21.18 | 311.27 | 1.048 | 0.20 | 0.40 | 20.03 | 17.58 | 16.10 | 142.89 |
| 15.00 | - 5.44 | 0.00 | 15.45 | 306.32 | 0.983 | 0.30 | 0.53 | 19.99 | 17.73 | 16.13 | 142.53 |
| 20.00 | - 5.58 | 0.00 | 9.73 | 301.03 | 0.915 | 0.40 | 0.62 | 19.94 | 17.88 | 16.16 | 142.18 |
| 25.00 | - 5.73 | 0.00 | 4.01 | 295.31 | 0.841 | 0.50 | 0.67 | 19.90 | 18.03 | 16.18 | 141.84 |
| 30.00 | - 5.89 | - 0.01 | - 1.70 | 289.04 | 0.760 | 0.60 | 0.67 | 19.86 | 18.18 | 16.21 | 141.49 |

| | |
|----------------------------------|------|
| Wheelbase (mm) | 2645 |
| Height of centre of gravity (mm) | 340 |

| | |
|--------------------------|---------|
| 100% anti-squat angle | 17,815° |
| Effect. Anti-squat angle | 4,875° |
| Anti-squat | 26,542% |

| | |
|----------------------------|--------|
| 100% anti-dive angle | 7,325° |
| Effective anti-div e angle | 0,530° |
| Anti-dive | 7,196% |

CHASSIS

Suspension adjustment Tables

30

REAR AXLE ASSEMBLY

Position of Suspension wishbones: 36 AF

| | |
|---|----------|
| Loaded wheel/tyre assembly radius | 283,92mm |
| Initial setting | |
| - Camber | - 5° |
| - Alignment | 0° |
| - body height (height between pads and ground): | |
| •Front | 25mm |
| •Rear | 35mm |

Position of actual suspension point (in mm)

| Point | Definition | X | Y | Z |
|-------|--|----------|---------|---------|
| 1 | Bottom Suspension wishbone, wheel side | 77.880 | 587.570 | 180.530 |
| 3 | Top Suspension wishbone, wheel side | -5.900 | 516.350 | 409.310 |
| 5 | Alignment bar, wheel side | - 69.160 | 583.780 | 170.130 |
| 6 | Push-rod, wheel side | 76.660 | 507.590 | 200.510 |
| 8 | Bottom point, tipper pivot axis | 21.900 | 125.030 | 355.640 |
| 9 | Top point, tipper pivot axis | 21.900 | 149.430 | 410.460 |
| 13 | Damper fastening point on tipper | 21.900 | 45.250 | 407.580 |
| 14 | Front fastener, bottom Suspension wishbone, gearbox side | 264.300 | 105.500 | 168.500 |
| 15 | Rear fastener, bottom Suspension wishbone, gearbox side | -110.490 | 105.500 | 152.300 |
| 16 | Front fastener, top Suspension wishbone, gearbox side | 214.300 | 106.440 | 338.080 |
| 17 | Rear fastener, top Suspension wishbone, gearbox side | -214.300 | 106.440 | 350.470 |
| 18 | Alignment bar, gear rack side | -110.490 | 105.500 | 152.300 |
| 19 | Push-rod, tipper side | 63.800 | 87.410 | 388.810 |
| 20 | Wheel centre | 0.000 | 634.730 | 283.920 |
| 26 | Rear damper fastening point | -297.970 | 47.630 | 390.340 |

| Wheel deflec. mm | Camb. degree | Align. degree | CR mm | Spr. I. mm | Motion ratio | Variat. Wbase mm | V In-Tr width mm | Wheel castor degree | C.gyra Rotat. degree | Rim/w offset mm | C. trail /offset mm |
|------------------|--------------|---------------|--------|------------|--------------|------------------|------------------|---------------------|----------------------|-----------------|---------------------|
| -30.00 | - 4.27 | - 0.05 | 61.38 | 342.89 | 1.512 | - 0.24 | - 1.89 | 20.55 | 16.56 | 15.81 | 146.74 |
| -25.00 | - 4.39 | - 0.04 | 55.68 | 339.50 | 1.458 | - 0.21 | - 1.47 | 20.47 | 16.68 | 15.85 | 146.21 |
| -20.00 | - 4.51 | - 0.03 | 49.98 | 335.98 | 1.403 | - 0.17 | - 1.09 | 20.40 | 16.80 | 15.89 | 145.68 |
| -15.00 | - 4.63 | - 0.02 | 44.29 | 332.32 | 1.347 | - 0.13 | - 0.75 | 20.33 | 16.92 | 15.93 | 145.15 |
| -10.00 | - 4.75 | - 0.01 | 38.60 | 328.51 | 1.291 | - 0.09 | - 0.46 | 20.26 | 17.04 | 15.97 | 144.63 |
| -5.00 | - 4.87 | 0.00 | 32.91 | 324.52 | 1.233 | - 0.05 | - 0.21 | 20.18 | 17.17 | 16.01 | 144.11 |
| 0.00 | - 5.00 | 0.00 | 27.23 | 320.34 | 1.175 | 0.00 | 0.00 | 20.11 | 17.29 | 16.04 | 143.59 |
| 5.00 | - 5.13 | 0.00 | 21.55 | 315.95 | 1.115 | 0.05 | 0.17 | 20.04 | 17.42 | 16.08 | 143.08 |
| 10.00 | - 5.26 | 0.00 | 15.88 | 311.31 | 1.053 | 0.10 | 0.29 | 19.97 | 17.55 | 16.11 | 142.57 |
| 15.00 | - 5.39 | 0.00 | 10.21 | 306.38 | 0.988 | 0.15 | 0.37 | 19.90 | 17.68 | 16.14 | 142.07 |
| 20.00 | - 5.52 | 0.00 | 4.54 | 301.12 | 0.919 | 0.20 | 0.41 | 19.83 | 17.82 | 16.18 | 141.57 |
| 25.00 | - 5.66 | - 0.01 | - 1.12 | 295.43 | 0.846 | 0.26 | 0.41 | 19.76 | 17.95 | 16.21 | 141.07 |
| 30.00 | - 5.80 | - 0.02 | - 6.77 | 289.20 | 0.765 | 0.32 | 0.37 | 19.69 | 18.09 | 16.24 | 140.57 |

| | |
|----------------------------------|------|
| Wheelbase (mm) | 2645 |
| Height of centre of gravity (mm) | 340 |

| | |
|--------------------------|---------|
| 100% anti-squat angle | 17,815° |
| Effect. Anti-squat angle | 5,923° |
| Anti-squat | 32,284% |

| | |
|----------------------------|---------|
| 100% anti-dive angle | 7,325° |
| Effective anti-div e angle | -0,324° |
| Anti-dive | -4,397% |

CHASSIS

Suspension adjustment Tables

30

REAR AXLE ASSEMBLY

Position of Suspension wishbones: 36 AE

| | |
|---|----------|
| Loaded wheel/tyre assembly radius | 283,92mm |
| Initial setting | |
| - Camber | - 5° |
| - Alignment | 0° |
| - body height (height between pads and ground): | |
| • Front | 25mm |
| • Rear | 35mm |

Position of actual suspension point (in mm)

| Point | Definition | X | Y | Z |
|-------|--|----------|---------|---------|
| 1 | Bottom Suspension wishbone, wheel side | 77.880 | 587.570 | 180.530 |
| 3 | Top Suspension wishbone, wheel side | -5.900 | 516.350 | 409.310 |
| 5 | Alignment bar, wheel side | - 69.160 | 583.780 | 170.130 |
| 6 | Push-rod, wheel side | 76.660 | 507.590 | 200.510 |
| 8 | Bottom point, tipper pivot axis | 21.900 | 125.030 | 355.640 |
| 9 | Top point, tipper pivot axis | 21.900 | 149.430 | 410.460 |
| 13 | Damper fastening point on tipper | 21.900 | 45.250 | 407.580 |
| 14 | Front fastener, bottom Suspension wishbone, gearbox side | 264.300 | 105.500 | 168.500 |
| 15 | Rear fastener, bottom Suspension wishbone, gearbox side | -110.490 | 105.500 | 152.300 |
| 16 | Front fastener, top Suspension wishbone, gearbox side | 214.300 | 106.440 | 348.080 |
| 17 | Rear fastener, top Suspension wishbone, gearbox side | -214.300 | 106.440 | 350.470 |
| 18 | Alignment bar, gear rack side | -110.490 | 105.500 | 152.300 |
| 19 | Push-rod, tipper side | 63.800 | 87.410 | 388.810 |
| 20 | Wheel centre | 0.000 | 634.730 | 283.920 |
| 26 | Rear damper fastening point | -297.970 | 47.630 | 390.340 |

| Wheel deflec. mm | Camb. degree | Align. degree | CR mm | Spr. I. mm | Motion ratio | Variat. Wbase mm | V In-Tr width mm | Wheel castor degree | C.gyra Rotat. degree | Rim/w offset mm | C. trail /offset mm |
|------------------|--------------|---------------|--------|------------|--------------|------------------|------------------|---------------------|----------------------|-----------------|---------------------|
| -30.00 | -4.33 | -0.05 | 56.57 | 343.11 | 1.499 | -0.54 | -1.73 | 20.39 | 16.62 | 15.85 | 145.80 |
| -25.00 | -4.44 | -0.04 | 50.79 | 339.69 | 1.445 | -0.45 | -1.33 | 20.35 | 16.73 | 15.88 | 145.42 |
| -20.00 | -4.55 | -0.03 | 45.02 | 336.14 | 1.390 | -0.37 | -0.98 | 20.30 | 16.84 | 15.92 | 145.05 |
| -15.00 | -4.66 | -0.02 | 39.25 | 332.44 | 1.334 | -0.28 | -0.67 | 20.25 | 16.95 | 15.95 | 144.68 |
| -10.00 | -4.77 | -0.01 | 33.48 | 328.59 | 1.278 | -0.19 | -0.40 | 20.21 | 17.06 | 15.98 | 144.32 |
| -5.00 | -4.88 | -0.01 | 27.72 | 324.56 | 1.221 | -0.09 | -0.18 | 20.16 | 17.18 | 16.01 | 143.96 |
| 0.00 | -5.00 | 0.00 | 21.97 | 320.34 | 1.162 | 0.00 | 0.00 | 20.11 | 17.29 | 16.04 | 143.59 |
| 5.00 | -5.12 | 0.00 | 16.22 | 315.90 | 1.102 | 0.10 | 0.14 | 20.07 | 17.41 | 16.07 | 143.24 |
| 10.00 | -5.24 | 0.01 | 10.47 | 311.21 | 1.040 | 0.19 | 0.23 | 20.02 | 17.53 | 16.10 | 142.88 |
| 15.00 | -5.36 | 0.01 | 4.73 | 306.22 | 0.975 | 0.29 | 0.28 | 19.98 | 17.65 | 16.13 | 142.53 |
| 20.00 | -5.48 | 0.01 | -1.00 | 300.88 | 0.907 | 0.39 | 0.29 | 19.93 | 17.77 | 16.15 | 142.17 |
| 25.00 | -5.61 | 0.01 | -6.74 | 295.11 | 0.833 | 0.49 | 0.25 | 19.89 | 17.90 | 16.18 | 141.82 |
| 30.00 | -5.73 | 0.00 | -12.46 | 288.78 | 0.751 | 0.59 | 0.18 | 19.84 | 18.02 | 16.21 | 141.48 |

| | |
|----------------------------------|------|
| Wheelbase (mm) | 2645 |
| Height of centre of gravity (mm) | 340 |

| | |
|--------------------------|---------|
| 100% anti-squat angle | 17,815° |
| Effect. Anti-squat angle | 4,751° |
| Anti-squat | 25,861% |

| | |
|---------------------------|--------|
| 100% anti-dive angle | 7,325° |
| Effective anti-dive angle | 0,631° |
| Anti-dive | 8,571% |

CHASSIS

Suspension adjustment Tables

30

REAR AXLE ASSEMBLY

Position of Suspension wishbones: 25 CG

| | |
|---|----------|
| Loaded wheel/tyre assembly radius | 283,92mm |
| Initial setting | |
| - Camber | - 5° |
| - Alignment | 0° |
| - body height (height between pads and ground): | |
| • Front | 25mm |
| • Rear | 35mm |

Position of actual suspension point (in mm)

| Point | Definition | X | Y | Z |
|-------|--|----------|---------|---------|
| 1 | Bottom Suspension wishbone, wheel side | 77.880 | 587.570 | 180.530 |
| 3 | Top Suspension wishbone, wheel side | -5.900 | 516.350 | 409.310 |
| 5 | Alignment bar, wheel side | - 69.160 | 583.780 | 170.130 |
| 6 | Push-rod, wheel side | 76.660 | 507.590 | 200.510 |
| 8 | Bottom point, tipper pivot axis | 21.900 | 125.030 | 355.640 |
| 9 | Top point, tipper pivot axis | 21.900 | 149.430 | 410.460 |
| 13 | Damper fastening point on tipper | 21.900 | 45.250 | 407.580 |
| 14 | Front fastener, bottom Suspension wishbone, gearbox side | 264.300 | 105.500 | 178.500 |
| 15 | Rear fastener, bottom Suspension wishbone, gearbox side | -110.490 | 105.500 | 162.300 |
| 16 | Front fastener, top Suspension wishbone, gearbox side | 214.300 | 106.440 | 328.080 |
| 17 | Rear fastener, top Suspension wishbone, gearbox side | -214.300 | 106.440 | 330.470 |
| 18 | Alignment bar, gear rack side | -110.490 | 105.500 | 152.300 |
| 19 | Push-rod, tipper side | 63.800 | 87.410 | 388.810 |
| 20 | Wheel centre | 0.000 | 634.730 | 283.920 |
| 26 | Rear damper fastening point | -297.970 | 47.630 | 390.340 |

| Wheel deflec. mm | Camb. degree | Align. degree | CR mm | Spr. I. mm | Motion ratio | Variat. Wbase mm | V In-Tr width mm | Wheel castor degree | C.gyra Rotat. degree | Rim/w offset mm | C. trail /offset mm |
|------------------|--------------|---------------|-------|------------|--------------|------------------|------------------|---------------------|----------------------|-----------------|---------------------|
| -30.00 | - 3.87 | 0.21 | 99.74 | 341.95 | 1.570 | - 0.89 | - 3.57 | 20.34 | 16.17 | 16.05 | 145.38 |
| -25.00 | - 4.06 | 0.17 | 93.95 | 338.68 | 1.516 | - 0.75 | - 2.87 | 20.30 | 16.35 | 16.05 | 145.08 |
| -20.00 | - 4.24 | 0.14 | 88.17 | 335.30 | 1.461 | - 0.60 | - 2.21 | 20.27 | 16.54 | 16.05 | 144.78 |
| -15.00 | - 4.43 | 0.11 | 82.40 | 331.79 | 1.406 | - 0.45 | - 1.59 | 20.23 | 16.72 | 16.05 | 144.48 |
| -10.00 | - 4.62 | 0.07 | 76.63 | 328.13 | 1.349 | - 0.30 | - 1.02 | 20.19 | 16.91 | 16.05 | 144.18 |
| -5.00 | - 4.81 | 0.04 | 70.88 | 324.33 | 1.292 | - 0.15 | - 0.49 | 20.15 | 17.10 | 16.04 | 143.89 |
| 0.00 | - 5.00 | 0.00 | 65.13 | 320.34 | 1.234 | 0.00 | 0.00 | 20.11 | 17.29 | 16.04 | 143.59 |
| 5.00 | - 5.19 | - 0.04 | 59.38 | 316.16 | 1.174 | 0.15 | 0.44 | 20.08 | 17.48 | 16.04 | 143.30 |
| 10.00 | - 5.39 | - 0.08 | 53.65 | 311.77 | 1.112 | 0.31 | 0.84 | 20.04 | 17.68 | 16.04 | 143.01 |
| 15.00 | - 5.58 | - 0.12 | 47.92 | 307.11 | 1.048 | 0.46 | 1.20 | 20.00 | 17.87 | 16.03 | 142.72 |
| 20.00 | - 5.78 | - 0.16 | 42.20 | 302.16 | 0.980 | 0.61 | 1.51 | 19.97 | 18.07 | 16.03 | 142.44 |
| 25.00 | - 5.97 | - 0.20 | 36.49 | 296.83 | 0.908 | 0.77 | 1.78 | 19.93 | 18.27 | 16.02 | 142.15 |
| 30.00 | - 6.17 | - 0.24 | 30.78 | 291.05 | 0.829 | 0.93 | 2.01 | 19.89 | 18.46 | 16.02 | 141.87 |

| | |
|----------------------------------|------|
| Wheelbase (mm) | 2645 |
| Height of centre of gravity (mm) | 340 |

| | |
|--------------------------|---------|
| 100% anti-squat angle | 17,815° |
| Effect. Anti-squat angle | 5,341° |
| Anti-squat | 29,092% |

| | |
|---------------------------|--------|
| 100% anti-dive angle | 7,325° |
| Effective anti-dive angle | 0,462° |
| Anti-dive | 6,278% |

CHASSIS

Suspension adjustment Tables

30

REAR AXLE ASSEMBLY

Position of Suspension wishbones: 25 CH

| | |
|---|----------|
| Loaded wheel/tyre assembly radius | 283,92mm |
| Initial setting | |
| - Camber | - 5° |
| - Alignment | 0° |
| - body height (height between pads and ground): | |
| •Front | 25mm |
| •Rear | 35mm |

Position of actual suspension point (in mm)

| Point | Definition | X | Y | Z |
|-------|--|----------|---------|---------|
| 1 | Bottom Suspension wishbone, wheel side | 77.880 | 587.570 | 180.530 |
| 3 | Top Suspension wishbone, wheel side | -5.900 | 516.350 | 409.310 |
| 5 | Alignment bar, wheel side | - 69.160 | 583.780 | 170.130 |
| 6 | Push-rod, wheel side | 76.660 | 507.590 | 200.510 |
| 8 | Bottom point, tipper pivot axis | 21.900 | 125.030 | 355.640 |
| 9 | Top point, tipper pivot axis | 21.900 | 149.430 | 410.460 |
| 13 | Damper fastening point on tipper | 21.900 | 45.250 | 407.580 |
| 14 | Front fastener, bottom Suspension wishbone, gearbox side | 264.300 | 105.500 | 178.500 |
| 15 | Rear fastener, bottom Suspension wishbone, gearbox side | -110.490 | 105.500 | 162.300 |
| 16 | Front fastener, top Suspension wishbone, gearbox side | 214.300 | 106.440 | 318.080 |
| 17 | Rear fastener, top Suspension wishbone, gearbox side | -214.300 | 106.440 | 330.470 |
| 18 | Alignment bar, gear rack side | -110.490 | 105.500 | 152.300 |
| 19 | Push-rod, tipper side | 63.800 | 87.410 | 388.810 |
| 20 | Wheel centre | 0.000 | 634.730 | 283.920 |
| 26 | Rear damper fastening point | -297.970 | 47.630 | 390.340 |

| Wheel deflec. mm | Camb. degree | Align. degree | CR mm | Spr. I. mm | Motion ratio | Variat. Wbase mm | V In-Tr width mm | Wheel castor degree | C.gyra Rotat. degree | Rim/w offset mm | C. trail /offset mm |
|------------------|--------------|---------------|--------|------------|--------------|------------------|------------------|---------------------|----------------------|-----------------|---------------------|
| -30.00 | - 3.82 | 0.21 | 104.24 | 341.75 | 1.584 | - 0.60 | - 3.72 | 20.49 | 16.11 | 16.01 | 146.30 |
| -25.00 | - 4.01 | 0.17 | 98.52 | 338.51 | 1.529 | - 0.51 | - 2.99 | 20.43 | 16.30 | 16.02 | 145.84 |
| -20.00 | - 4.21 | 0.14 | 92.80 | 335.16 | 1.474 | - 0.41 | - 2.30 | 20.36 | 16.50 | 16.02 | 145.39 |
| -15.00 | - 4.40 | 0.11 | 87.09 | 331.68 | 1.419 | - 0.31 | - 1.66 | 20.30 | 16.69 | 16.03 | 144.94 |
| -10.00 | - 4.60 | 0.07 | 81.38 | 328.06 | 1.362 | - 0.21 | - 1.07 | 20.24 | 16.89 | 16.03 | 144.49 |
| -5.00 | - 4.80 | 0.04 | 75.69 | 324.28 | 1.305 | - 0.10 | - 0.51 | 20.18 | 17.09 | 16.04 | 144.04 |
| 0.00 | - 5.00 | 0.00 | 69.99 | 320.34 | 1.247 | 0.00 | 0.00 | 20.11 | 17.29 | 16.04 | 143.59 |
| 5.00 | - 5.20 | - 0.04 | 64.31 | 316.21 | 1.187 | 0.11 | 0.47 | 20.05 | 17.49 | 16.05 | 143.15 |
| 10.00 | - 5.41 | - 0.08 | 58.63 | 311.86 | 1.125 | 0.21 | 0.89 | 19.99 | 17.70 | 16.05 | 142.72 |
| 15.00 | - 5.61 | - 0.12 | 52.96 | 307.26 | 1.061 | 0.32 | 1.28 | 19.93 | 17.90 | 16.05 | 142.28 |
| 20.00 | - 5.82 | - 0.17 | 47.30 | 302.37 | 0.993 | 0.43 | 1.62 | 19.87 | 18.11 | 16.05 | 141.85 |
| 25.00 | - 6.02 | - 0.21 | 41.64 | 297.12 | 0.921 | 0.54 | 1.92 | 19.81 | 18.32 | 16.05 | 141.42 |
| 30.00 | - 6.23 | - 0.26 | 35.99 | 291.42 | 0.843 | 0.66 | 2.17 | 19.75 | 18.52 | 16.05 | 140.99 |

| | |
|----------------------------------|------|
| Wheelbase (mm) | 2645 |
| Height of centre of gravity (mm) | 340 |

| | |
|--------------------------|---------|
| 100% anti-squat angle | 17,815° |
| Effect. Anti-squat angle | 6,836° |
| Anti-squat | 37,306% |

| | |
|----------------------------|---------|
| 100% anti-dive angle | 7,325° |
| Effective anti-div e angle | -0,595° |
| Anti-dive | -8,083% |

CHASSIS

Suspension adjustment Tables

30

REAR AXLE ASSEMBLY

Position of Suspension wishbones: 25 BG

| | |
|---|----------|
| Loaded wheel/tyre assembly radius | 283,92mm |
| Initial setting | |
| - Camber | - 5° |
| - Alignment | 0° |
| - body height (height between pads and ground): | |
| •Front | 25mm |
| •Rear | 35mm |

Position of actual suspension point (in mm)

| Point | Definition | X | Y | Z |
|-------|--|----------|---------|---------|
| 1 | Bottom Suspension wishbone, wheel side | 77.880 | 587.570 | 180.530 |
| 3 | Top Suspension wishbone, wheel side | -5.900 | 516.350 | 409.310 |
| 5 | Alignment bar, wheel side | - 69.160 | 583.780 | 170.130 |
| 6 | Push-rod, wheel side | 76.660 | 507.590 | 200.510 |
| 8 | Bottom point, tipper pivot axis | 21.900 | 125.030 | 355.640 |
| 9 | Top point, tipper pivot axis | 21.900 | 149.430 | 410.460 |
| 13 | Damper fastening point on tipper | 21.900 | 45.250 | 407.580 |
| 14 | Front fastener, bottom Suspension wishbone, gearbox side | 264.300 | 105.500 | 178.500 |
| 15 | Rear fastener, bottom Suspension wishbone, gearbox side | -110.490 | 105.500 | 162.300 |
| 16 | Front fastener, top Suspension wishbone, gearbox side | 214.300 | 106.440 | 328.080 |
| 17 | Rear fastener, top Suspension wishbone, gearbox side | -214.300 | 106.440 | 340.470 |
| 18 | Alignment bar, gear rack side | -110.490 | 105.500 | 152.300 |
| 19 | Push-rod, tipper side | 63.800 | 87.410 | 388.810 |
| 20 | Wheel centre | 0.000 | 634.730 | 283.920 |
| 26 | Rear damper fastening point | -297.970 | 47.630 | 390.340 |

| Wheel deflec. mm | Camb. degree | Align. degree | CR mm | Spr. I. mm | Motion ratio | Variat. Wbase mm | V In-Tr width mm | Wheel castor degree | C.gyra Rotat. degree | Rim/w offset mm | C. trail /offset mm |
|------------------|--------------|---------------|-------|------------|--------------|------------------|------------------|---------------------|----------------------|-----------------|---------------------|
| -30.00 | - 3.97 | 0.19 | 94.30 | 341.86 | 1.576 | - 0.59 | - 3.24 | 20.51 | 16.26 | 16.01 | 146.33 |
| -25.00 | - 4.14 | 0.17 | 88.57 | 338.61 | 1.522 | - 0.49 | - 2.60 | 20.44 | 16.43 | 16.02 | 145.87 |
| -20.00 | -4.31 | 0.14 | 82.84 | 335.24 | 1.467 | - 0.40 | - 1.99 | 20.38 | 16.60 | 16.02 | 145.41 |
| -15.00 | - 4.48 | 0.10 | 77.12 | 331.74 | 1.411 | - 0.30 | - 1.43 | 20.31 | 16.77 | 16.03 | 144.95 |
| -10.00 | - 4.65 | 0.07 | 71.41 | 328.10 | 1.355 | - 0.20 | - 0.91 | 20.24 | 16.94 | 16.03 | 144.49 |
| -5.00 | - 4.82 | 0.04 | 65.70 | 324.31 | 1.297 | - 0.10 | - 0.43 | 20.18 | 17.12 | 16.04 | 144.04 |
| 0.00 | - 5.00 | 0.00 | 60.00 | 320.34 | 1.239 | 0.00 | 0.00 | 20.11 | 17.29 | 16.04 | 143.59 |
| 5.00 | -5.18 | -0.04 | 54.31 | 316.18 | 1.179 | 0.10 | 0.39 | 20.05 | 17.47 | 16.04 | 143.15 |
| 10.00 | - 5.36 | - 0.08 | 48.62 | 311.80 | 1.117 | 0.21 | 0.74 | 19.98 | 17.65 | 16.05 | 142.71 |
| 15.00 | - 5.54 | - 0.12 | 42.94 | 307.17 | 1.053 | 0.32 | 1.04 | 19.92 | 17.83 | 16.05 | 142.27 |
| 20.00 | - 5.72 | - 0.16 | 37.26 | 302.24 | 0.985 | 0.42 | 1.31 | 19.85 | 18.01 | 16.05 | 141.83 |
| 25.00 | - 5.90 | - 0.21 | 31.59 | 296.94 | 0.913 | 0.53 | 1.53 | 19.79 | 18.19 | 16.05 | 141.40 |
| 30.00 | - 6.09 | - 0.25 | 25.93 | 291.19 | 0.834 | 0.64 | 1.70 | 19.73 | 18.38 | 16.05 | 140.97 |

| | |
|----------------------------------|------|
| Wheelbase (mm) | 2645 |
| Height of centre of gravity (mm) | 340 |

| | |
|--------------------------|---------|
| 100% anti-squat angle | 17,815° |
| Effect. Anti-squat angle | 6,577° |
| Anti-squat | 35,880% |

| | |
|----------------------------|---------|
| 100% anti-dive angle | 7,325° |
| Effective anti-div e angle | 0,412° |
| Anti-dive | -5,589% |

CHASSIS

Suspension adjustment Tables

30

REAR AXLE ASSEMBLY

Position of Suspension wishbones: 25 BF

| | |
|---|----------|
| Loaded wheel/tyre assembly radius | 283,92mm |
| Initial setting | |
| - Camber | - 5° |
| - Alignment | 0° |
| - body height (height between pads and ground): | |
| •Front | 25mm |
| •Rear | 35mm |

Position of actual suspension point (in mm)

| Point | Definition | X | Y | Z |
|-------|--|----------|---------|---------|
| 1 | Bottom Suspension wishbone, wheel side | 77.880 | 587.570 | 180.530 |
| 3 | Top Suspension wishbone, wheel side | -5.900 | 516.350 | 409.310 |
| 5 | Alignment bar, wheel side | - 69.160 | 583.780 | 170.130 |
| 6 | Push-rod, wheel side | 76.660 | 507.590 | 200.510 |
| 8 | Bottom point, tipper pivot axis | 21.900 | 125.030 | 355.640 |
| 9 | Top point, tipper pivot axis | 21.900 | 149.430 | 410.460 |
| 13 | Damper fastening point on tipper | 21.900 | 45.250 | 407.580 |
| 14 | Front fastener, bottom Suspension wishbone, gearbox side | 264.300 | 105.500 | 178.500 |
| 15 | Rear fastener, bottom Suspension wishbone, gearbox side | -110.490 | 105.500 | 162.300 |
| 16 | Front fastener, top Suspension wishbone, gearbox side | 214.300 | 106.440 | 338.080 |
| 17 | Rear fastener, top Suspension wishbone, gearbox side | -214.300 | 106.440 | 340.470 |
| 18 | Alignment bar, gear rack side | -110.490 | 105.500 | 152.300 |
| 19 | Push-rod, tipper side | 63.800 | 87.410 | 388.810 |
| 20 | Wheel centre | 0.000 | 634.730 | 283.920 |
| 26 | Rear damper fastening point | -297.970 | 47.630 | 390.340 |

| Wheel deflec. mm | Camb. degree | Align. degree | CR mm | Spr. I. mm | Motion ratio | Variat. Wbase mm | V In-Tr width mm | Wheel castor degree | C.gyra Rotat. degree | Rim/w offset mm | C. trail /offset mm |
|------------------|--------------|---------------|-------|------------|--------------|------------------|------------------|---------------------|----------------------|-----------------|---------------------|
| -30.00 | - 4.03 | 0.20 | 89.70 | 342.07 | 1.563 | - 0.88 | - 3.10 | 20.36 | 16.32 | 16.05 | 145.40 |
| -25.00 | - 4.19 | 0.17 | 83.90 | 338.79 | 1.509 | - 0.74 | - 2.47 | 20.32 | 16.48 | 16.05 | 145.09 |
| -20.00 | - 4.35 | 0.13 | 78.11 | 335.39 | 1.454 | - 0.59 | - 1.89 | 20.28 | 16.64 | 16.05 | 144.79 |
| -15.00 | -4.51 | 0.10 | 72.32 | 331.86 | 1.398 | - 0.45 | - 1.35 | 20.24 | 16.80 | 16.05 | 144.49 |
| -10.00 | - 4.67 | 0.07 | 66.54 | 328.18 | 1.342 | - 0.30 | - 0.86 | 20.19 | 16.96 | 16.05 | 144.19 |
| -5.00 | - 4.83 | 0.04 | 60.77 | 324.35 | 1.285 | - 0.15 | - 0.41 | 20.15 | 17.13 | 16.05 | 143.89 |
| 0.00 | - 5.00 | 0.00 | 55.01 | 320.34 | 1.226 | 0.00 | 0.00 | 20.11 | 17.29 | 16.04 | 143.59 |
| 5.00 | -5.17 | -0.04 | 49.25 | 316.14 | 1.166 | 0.15 | 0.36 | 20.07 | 17.46 | 16.04 | 143.30 |
| 10.00 | -5.34 | -0.07 | 43.50 | 311.71 | 1.104 | 0.30 | 0.68 | 20.03 | 17.63 | 16.03 | 143.01 |
| 15.00 | - 5.51 | - 0.11 | 37.75 | 307.02 | 1.040 | 0.46 | 0.96 | 19.99 | 17.80 | 16.03 | 142.72 |
| 20.00 | - 5.68 | - 0.15 | 32.02 | 302.02 | 0.972 | 0.61 | 1.19 | 19.95 | 17.97 | 16.02 | 142.43 |
| 25.00 | - 5.85 | - 0.19 | 26.29 | 296.65 | 0.899 | 0.76 | 1.39 | 19.91 | 18.14 | 16.02 | 142.14 |
| 30.00 | - 6.02 | - 0.23 | 20.56 | 290.81 | 0.820 | 0.92 | 1.53 | 19.88 | 18.32 | 16.01 | 141.86 |

| | |
|----------------------------------|------|
| Wheelbase (mm) | 2645 |
| Height of centre of gravity (mm) | 340 |

| | |
|--------------------------|---------|
| 100% anti-squat angle | 17,815° |
| Effect. Anti-squat angle | 5,175° |
| Anti-squat | 28,184% |

| | |
|----------------------------|--------|
| 100% anti-dive angle | 7,325° |
| Effective anti-div e angle | 0,579° |
| Anti-dive | 7,866% |

CHASSIS

Suspension adjustment Tables

30

REAR AXLE ASSEMBLY

Position of Suspension wishbones: 25 AF

| | |
|---|----------|
| Loaded wheel/tyre assembly radius | 283,92mm |
| Initial setting | |
| - Camber | - 5° |
| - Alignment | 0° |
| - body height (height between pads and ground): | |
| •Front | 25mm |
| •Rear | 35mm |

Position of actual suspension point (in mm)

| Point | Definition | X | Y | Z |
|-------|--|----------|---------|---------|
| 1 | Bottom Suspension wishbone, wheel side | 77.880 | 587.570 | 180.530 |
| 3 | Top Suspension wishbone, wheel side | -5.900 | 516.350 | 409.310 |
| 5 | Alignment bar, wheel side | - 69.160 | 583.780 | 170.130 |
| 6 | Push-rod, wheel side | 76.660 | 507.590 | 200.510 |
| 8 | Bottom point, tipper pivot axis | 21.900 | 125.030 | 355.640 |
| 9 | Top point, tipper pivot axis | 21.900 | 149.430 | 410.460 |
| 13 | Damper fastening point on tipper | 21.900 | 45.250 | 407.580 |
| 14 | Front fastener, bottom Suspension wishbone, gearbox side | 264.300 | 105.500 | 178.500 |
| 15 | Rear fastener, bottom Suspension wishbone, gearbox side | -110.490 | 105.500 | 162.300 |
| 16 | Front fastener, top Suspension wishbone, gearbox side | 214.300 | 106.440 | 338.080 |
| 17 | Rear fastener, top Suspension wishbone, gearbox side | -214.300 | 106.440 | 350.470 |
| 18 | Alignment bar, gear rack side | -110.490 | 105.500 | 152.300 |
| 19 | Push-rod, tipper side | 63.800 | 87.410 | 388.810 |
| 20 | Wheel centre | 0.000 | 634.730 | 283.920 |
| 26 | Rear damper fastening point | -297.970 | 47.630 | 390.340 |

| Wheel deflec. mm | Camb. degree | Align. degree | CR mm | Spr. I. mm | Motion ratio | Variat. Wbase mm | V In-Tr width mm | Wheel castor degree | C.gyra Rotat. degree | Rim/w offset mm | C. trail /offset mm |
|------------------|--------------|---------------|-------|------------|--------------|------------------|------------------|---------------------|----------------------|-----------------|---------------------|
| -30.00 | - 4.13 | 0.18 | 84.07 | 341.98 | 1.569 | - 0.57 | - 2.76 | 20.53 | 16.42 | 16.01 | 146.36 |
| -25.00 | - 4.27 | 0.16 | 78.33 | 338.71 | 1.514 | - 0.48 | - 2.19 | 20.46 | 16.56 | 16.02 | 145.89 |
| -20.00 | - 4.41 | 0.13 | 72.60 | 335.33 | 1.459 | - 0.39 | - 1.67 | 20.39 | 16.70 | 16.03 | 145.43 |
| -15.00 | - 4.56 | 0.10 | 66.88 | 331.81 | 1.404 | - 0.29 | - 1.19 | 20.32 | 16.85 | 16.03 | 144.96 |
| -10.00 | - 4.70 | 0.07 | 61.16 | 328.15 | 1.347 | - 0.20 | - 0.75 | 20.25 | 16.99 | 16.04 | 144.50 |
| -5.00 | - 4.85 | 0.03 | 55.44 | 324.33 | 1.290 | - 0.10 | - 0.35 | 20.18 | 17.14 | 16.04 | 144.05 |
| 0.00 | - 5.00 | 0.00 | 49.73 | 320.34 | 1.231 | 0.00 | 0.00 | 20.11 | 17.29 | 16.04 | 143.59 |
| 5.00 | - 5.15 | - 0.04 | 44.03 | 316.15 | 1.171 | 0.10 | 0.31 | 20.04 | 17.44 | 16.04 | 143.15 |
| 10.00 | - 5.30 | - 0.07 | 38.33 | 311.74 | 1.109 | 0.20 | 0.58 | 19.98 | 17.60 | 16.04 | 142.70 |
| 15.00 | - 5.46 | - 0.11 | 32.64 | 307.07 | 1.044 | 0.31 | 0.80 | 19.91 | 17.75 | 16.04 | 142.25 |
| 20.00 | - 5.62 | - 0.16 | 26.95 | 302.10 | 0.976 | 0.42 | 0.99 | 19.84 | 17.91 | 16.04 | 141.81 |
| 25.00 | - 5.77 | - 0.20 | 21.27 | 296.76 | 0.904 | 0.52 | 1.13 | 19.77 | 18.07 | 16.04 | 141.38 |
| 30.00 | - 5.93 | - 0.24 | 15.60 | 290.95 | 0.825 | 0.63 | 1.22 | 19.71 | 18.23 | 16.04 | 140.94 |

| | |
|----------------------------------|------|
| Wheelbase (mm) | 2645 |
| Height of centre of gravity (mm) | 340 |

| | |
|--------------------------|---------|
| 100% anti-squat angle | 17,815° |
| Effect. Anti-squat angle | 6,347° |
| Anti-squat | 34,614% |

| | |
|----------------------------|---------|
| 100% anti-dive angle | 7,325° |
| Effective anti-div e angle | -0,249° |
| Anti-dive | -3,376% |