

REFERENCE	BT_2013_FR20_15_UK
DATE	September 10th, 2013
SUBJECT	Front wing support modification, steering column modification, engine cover modification
PART	Front wing support, front wing support closing plate, steering column, engine cover

1. Front wing support modification
a. Modification details

In order to allow a higher amount of deformation to the front wing supports in case of slight contacts, their design has been modified as shown below:

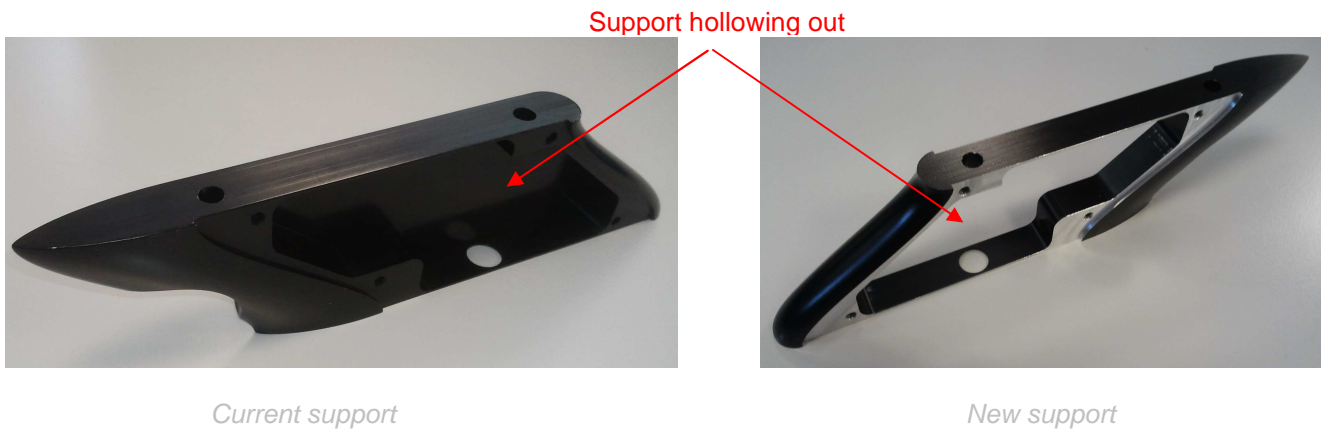

Moreover, aluminium support closing plates have been replaced by plastic ones fitted on each side of the support (2 plates per support).

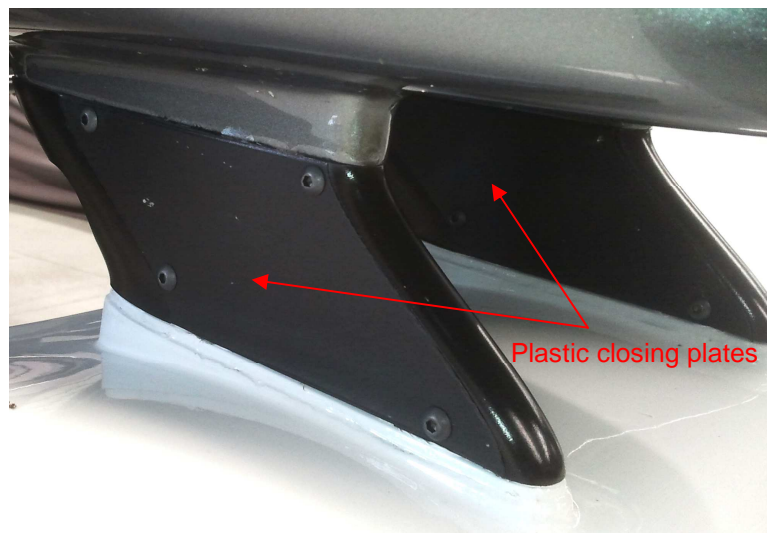

This new front wing support assembly has been tested successfully ensuring its mechanical resistance and breaking failure under crashes.



b. New front wing supports and closing plates deployment

New front wing supports and plastic closing plates are now available at Alpine under the following references:

- Front wing support (compatible left/right) ref: 77 11 167 720
- Plastic closing plates ref: 77 11 167 721

However, according to the additional cost for teams caused by the current front wing supports since the beginning of the season, Renault Sport has created a new front wing support kit ref. 00 11 167 720, available at a discounted price of 87.80€ excl. VAT. Only one kit per FR2013 car/kit is available at this specific price.

The kit includes:

- 2 front wing supports ref: 77 11 167 720
- 4 plastic closing plates ref: 77 11 167 721

This kit will be available until the end of 2013 season as detailed below:

- For Eurocup teams, the kits have to be purchased directly at the Renault Sport spare parts truck. They will be available from Thursday afternoon at the Hungaroring WSR event
- For ALPS & NEC cars (not entering Eurocup), the kits have to be purchased directly through the championship allocated dealer. The respective dealers will arrange the kits distribution from:
 - Zandvoort event for the NEC championship
 - Imola event for the ALPS championship
- For other customers, kits has to be ordered directly to Alpine emailing the spare parts department to the following contacts :

rst-parts.dpt@renault.com
melanie.berthelot@renault.com

Alpine will then send you directly the kits to your attention.

Moreover, every brand new current front wing support you may have in stock can be exchanged for free by new one. However, due to the limited amount of new front wing supports available at the moment, the part exchange will only be effective from September 30th.

c. Technical regulation

The new front wing support (ref: 77 11 167 720) and plastic closing plate (ref: 77 11 167 721) are now allowed to be fitted on the car.

The current front wing supports left & right (ref: 77 11 166 784 & ref: 77 11 166 785) and aluminium closing plates (ref: 77 11 166 786) are still allowed until end of 2013 season.

2. Steering column modification

In case of presence of play between the steering column tube (blue) and the absorber centering part (green), it's allowed to make a weld bead (red) around the junction of the two parts assembly to block them.

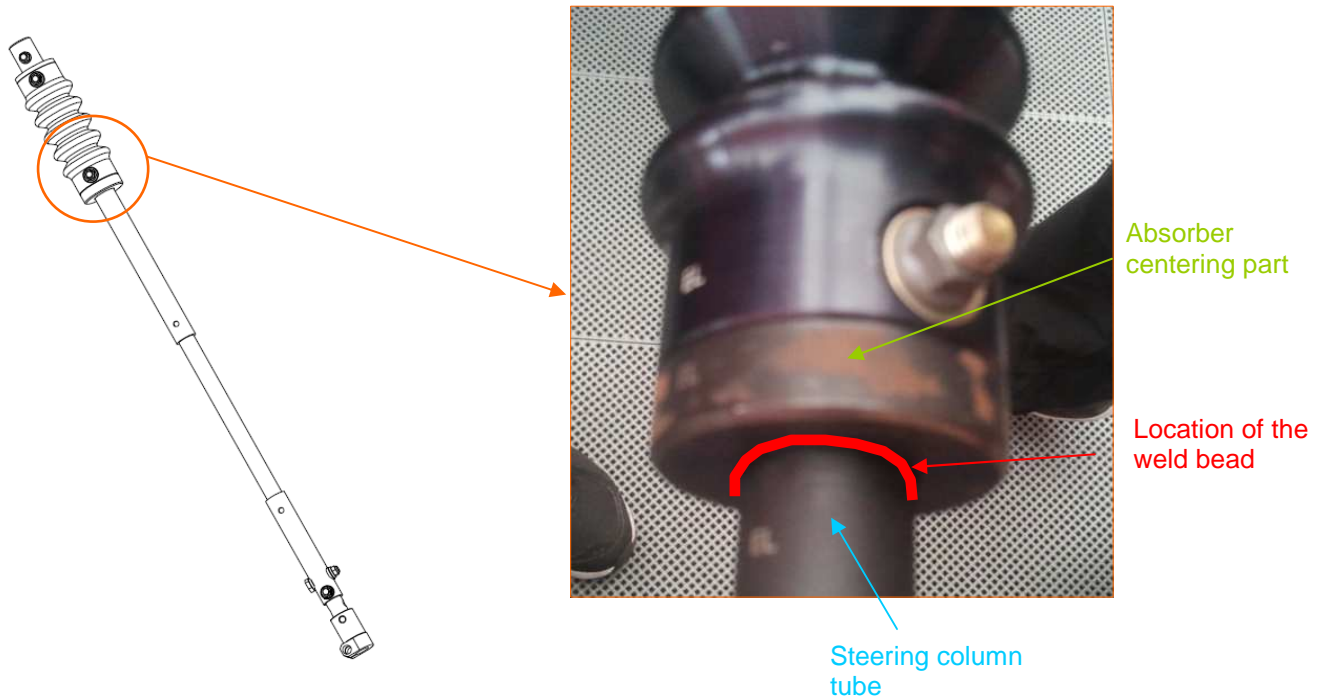

3. Engine cover adjustment

Upper rear wishbone brackets may enter in interference with the engine cover when they are setting up in the upper position (Rear A-arms options 2 and 5). To avoid any interference, it's allowed to slightly adjust the engine cover around the upper rear A-arm brackets.

