

REFERENCE	BT_2013_FR20_8_UK
DATE	19th March, 2013
SUBJECT	New transponder position / ECU protection bag
PART	Transponder, LH floor, ECU door, ECU

1. New transponder position

A better location for the transponder has been tried successfully during pre-season collective tests, inside the LH carbon floor.

The transponder must now be fitted to the ECU tray using Velcro® as shown below:

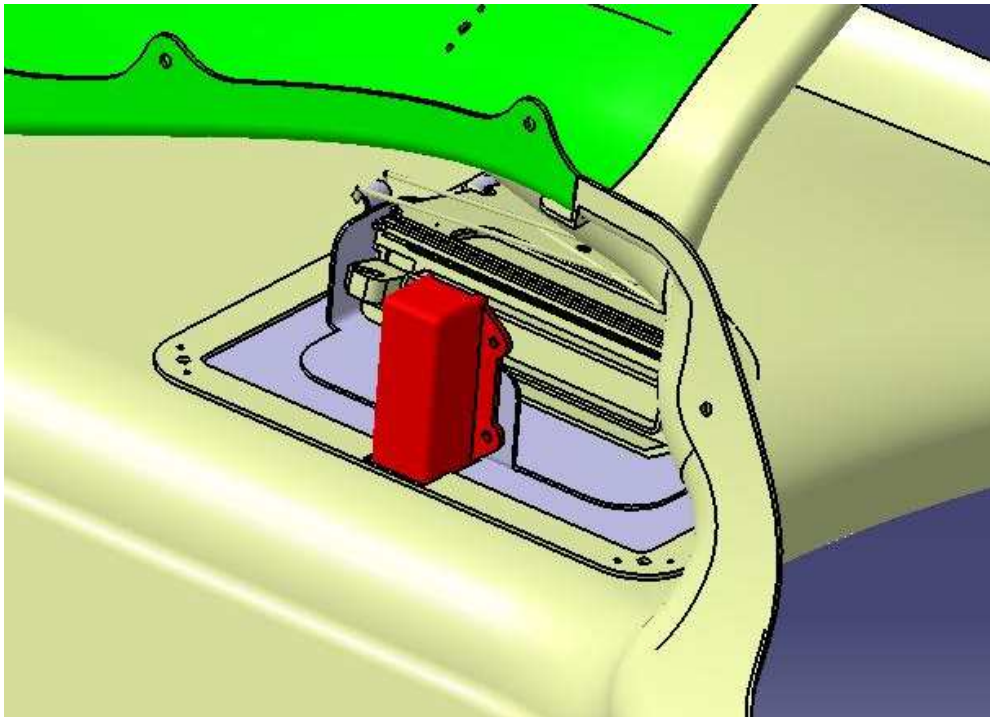

To realize this mounting, the following procedure has to be respected:

- a. Cut the ECU door and drill new holes following the sketch below (modifications to do in red) :

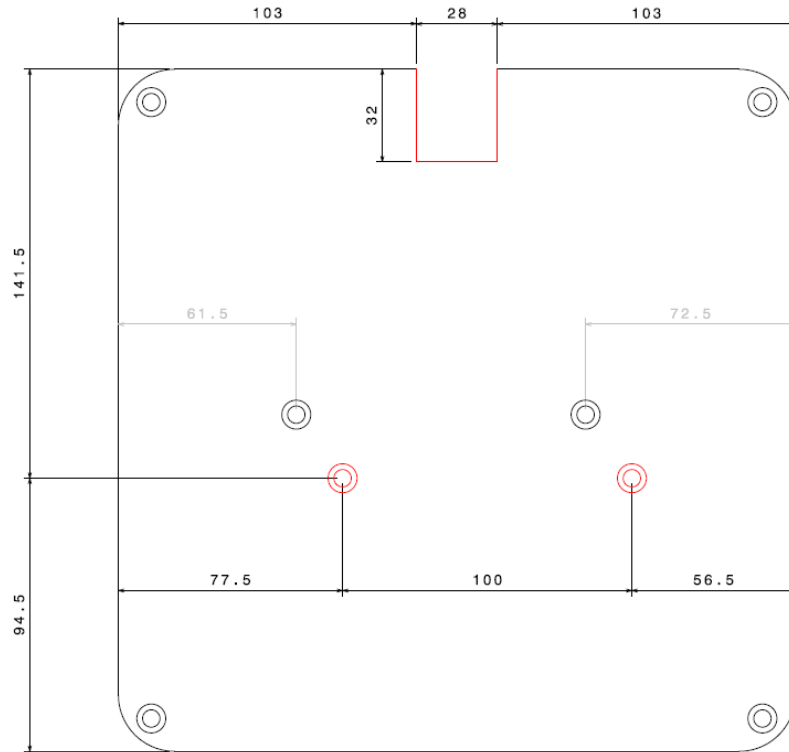

- b. Cut the LH carbon floor in the fitting area of the ECU door according the new ECU door hole.

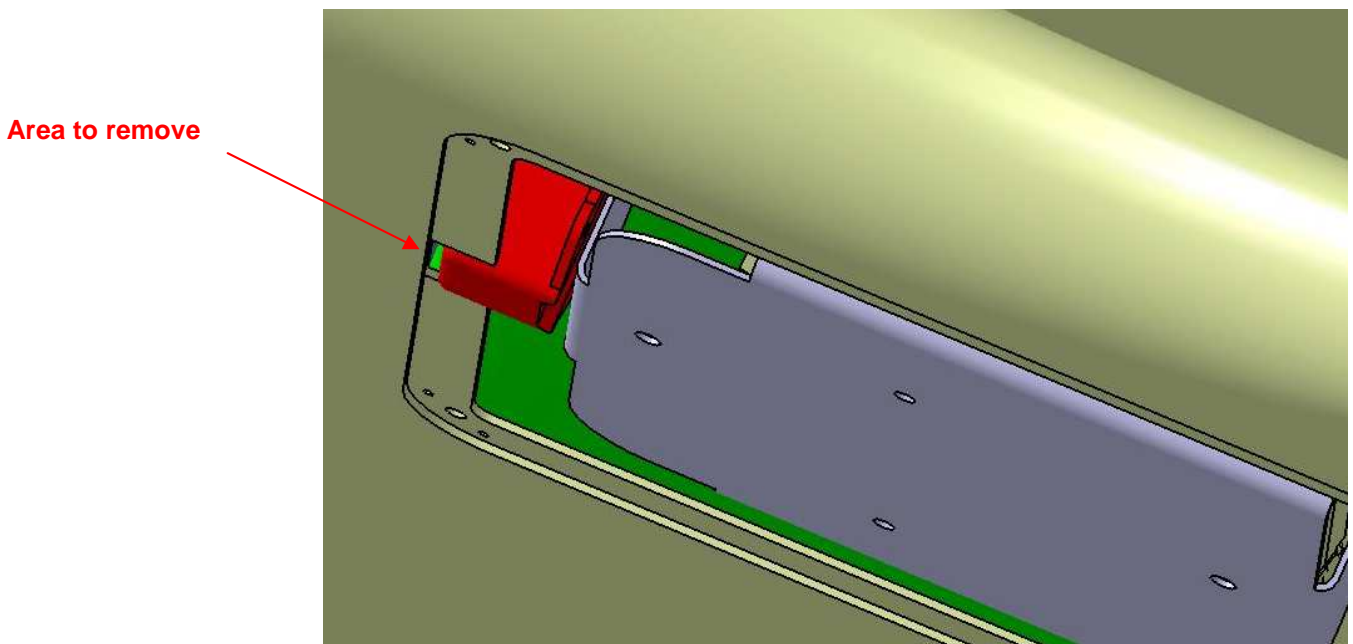

- c. Fit the transponder on the main lug of the ECU tray using Velcro®. The bottom of the transponder must be tangent to the lower face of the ECU support plate.

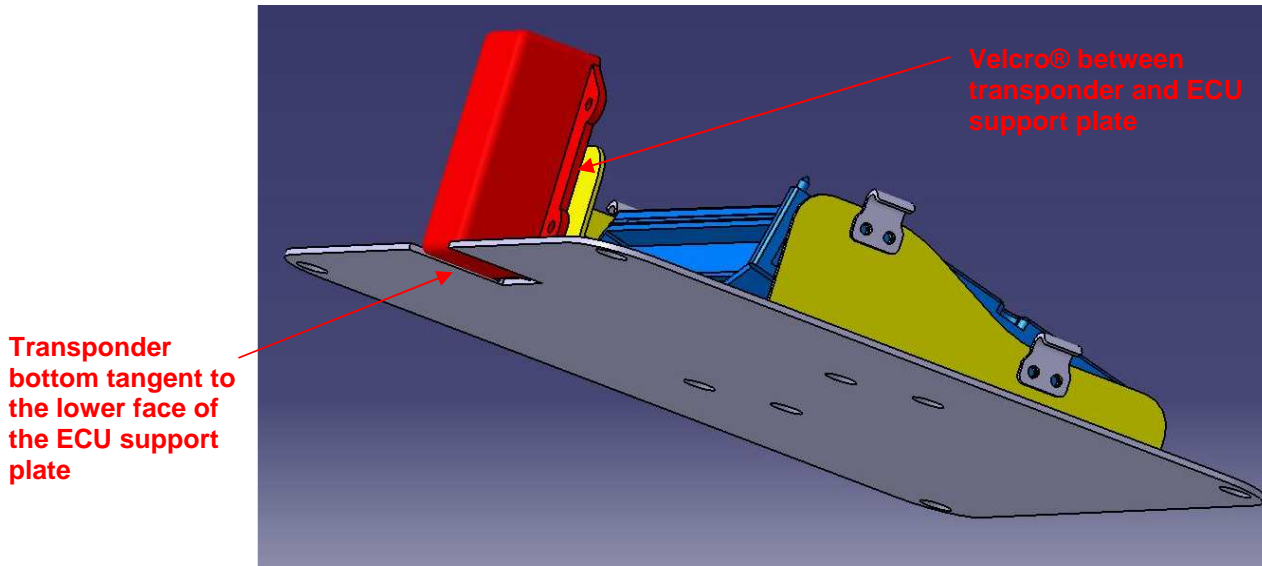

- d. Make a loop with the wire using Ty-Rap®.
- e. Once the transponder is fitted, the mounting will look like as follow:

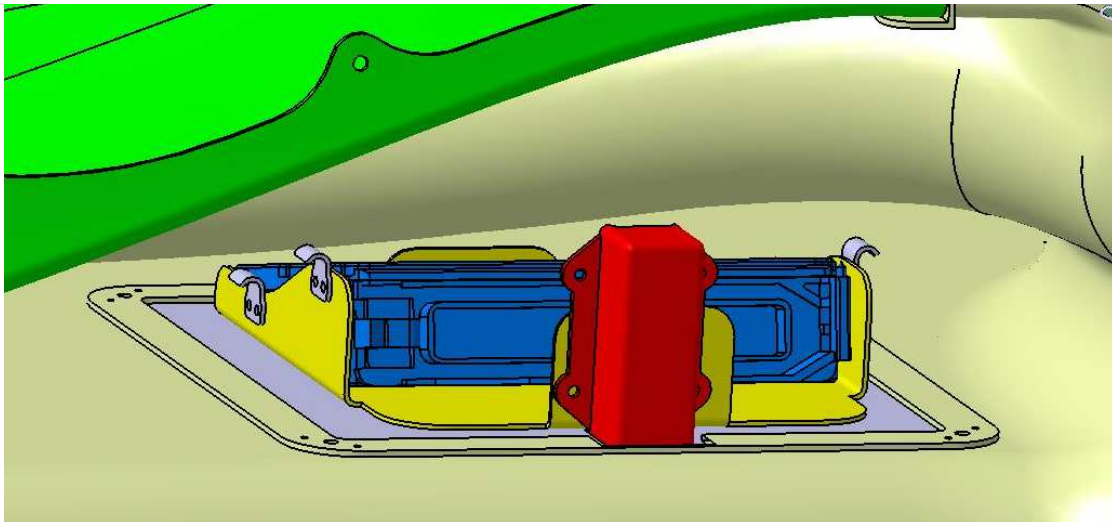

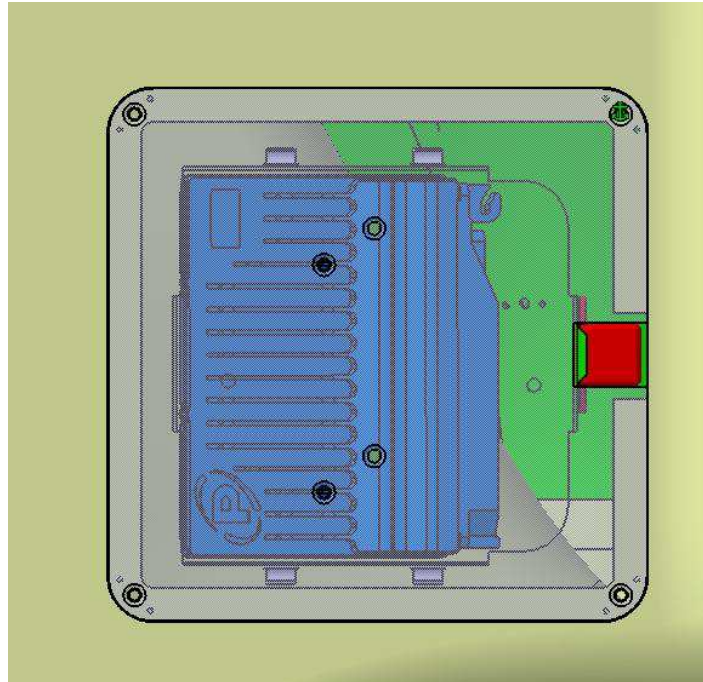

Note: to respect this mounting, we remind you that the ECU tray must be re-drilled as per Technical Bulletin #1 2013.

2. ECU protection bag

After having encountered some issues with water coming inside the ECU connection, we strongly advise teams to wrap their ECU, plugged with the engine loom, into a sealed plastic bag during rain sessions. This solution must be considered as provisional, Renault Sport is currently trying to find a proper solution to this problem.

The following procedure is recommended to prevent your ECU connector from water ingress while running:

- a. Take a thin plastic bag for food use for instance.
- b. Ensure the bag, the ECU and the loom connector are completely dry.
- c. Put your ECU plugged with the engine loom into a plastic bag.



- d. Close your bag with the sealing system till the loom.



- e. Wrap tightly the rest of the bag around the loom.



- f. Wrap tightly with tape the bag around the loom.



- g. Fit the ECU back into its support.

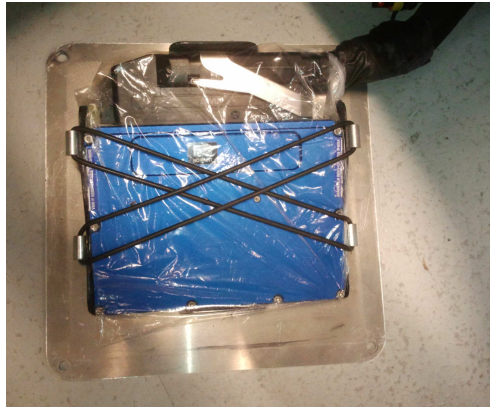

Note: we advise you to check often the ECU protection bag from water ingress or condensation between rain sessions.